



## Five Bedroom House

**St. Swithins Road, Fleet, Hampshire, GU51 1GL**

Offers in excess of: £725,000

- Four/Five Bedrooms
- Elvetham Heath
- Double Garage
- Versatile Living Space
- Viewing Advised
- Parking to Rear
- Private Rear Garden
- EPC : C (77)



## Description

A beautifully presented and modern family home, situated in the sought-after residential development of Elvetham Heath, close to local amenities and excellent schools, this property offers a perfect balance of modern living and comfort with a generous amount of versatile living accommodation across three floors. Features to note include: A secluded corner plot, private rear garden, four/five bedrooms, two En suites, a double garage and parking. Don't miss out on the opportunity to make this exceptional house your new home. Contact us today to arrange a viewing.

## Outside

The property is nestled at the end of a cul-de-sac and benefits from a double garage and parking to the rear, a foot path leads from the parking area to the main front door and past a generous front lawn which is bordered by mature hedging. An enclosed rear garden offers a patio seating area and artificial lawn, offering the perfect spot for alfresco dining.

## Floorplan

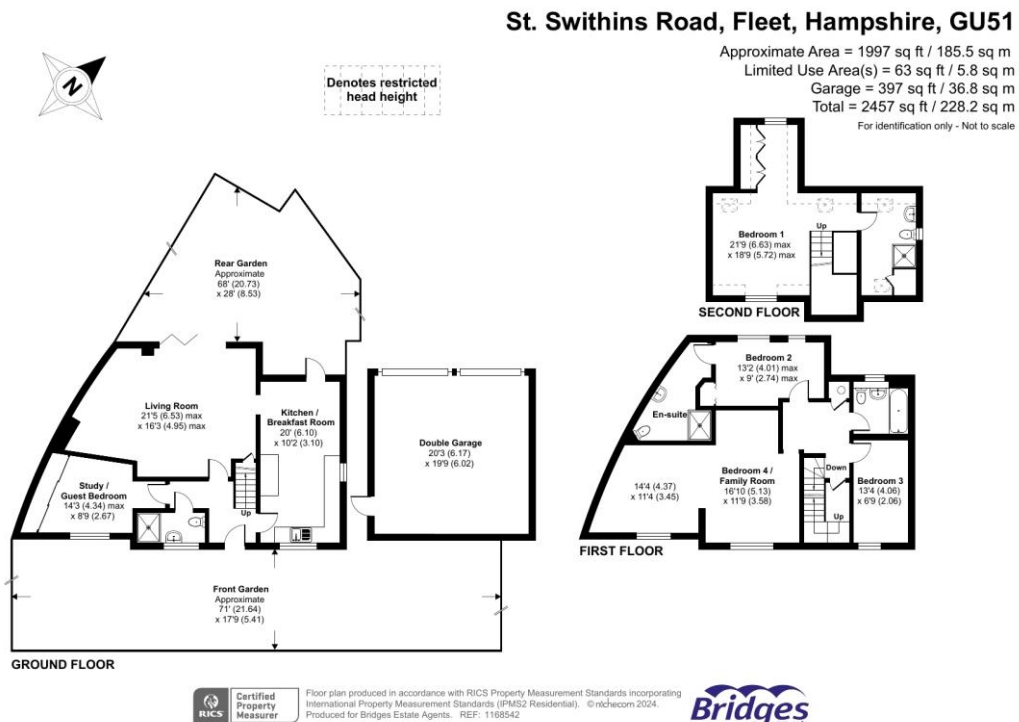

To arrange a viewing please contact:

Tel: 01252 361550

Email: [info@bridges.co.uk](mailto:info@bridges.co.uk)

Important Notice - These particulars are set out as a general outline only for the guidance of intended purchasers and do not form part of any offer or contract and must not be relied upon as statements or representations of fact. Purchasers must satisfy themselves by inspection or otherwise as to their correctness.