



## Two Bedroom Mobile Home

**Hill Corner Farm Park, Sandy Lane, Farnborough, Hampshire, GU14**

Price: £180,000

- Two Bedrooms
- Park Home
- Private Community
- Residents Aged 55 Years and Over
- Newly Laid Roads and Infrastructures
- Brand New Development
- Utilities Connected to Mains Services
- EPC : N/A



## Description

A modern two bedroom park home situated on a new development located on the edge of Farnborough and Camberley (Hampshire and Surrey Borders). Hill Corner Farm Park is owned by a family run group.

This accommodation comprises two bedrooms, a fitted kitchen with plenty of counter space, a pristine three piece bathroom suite with a shower, and a dual aspect lounge with sliding patio doors out to a raised seating area.

Situated on a spacious plot the property benefits from a well presented wrap around garden area ideal for any keen gardeners, and also offers driveway parking for a vehicle.

## Outside

A spacious wrap around garden plot that has been tastefully designed by the current owners. Offering some great space to enjoy the sunshine and a low maintenance but colourful setting with an array of potted plants, hanging baskets, flowers beds, and a raised patio.

## Floorplan

### GROUND FLOOR

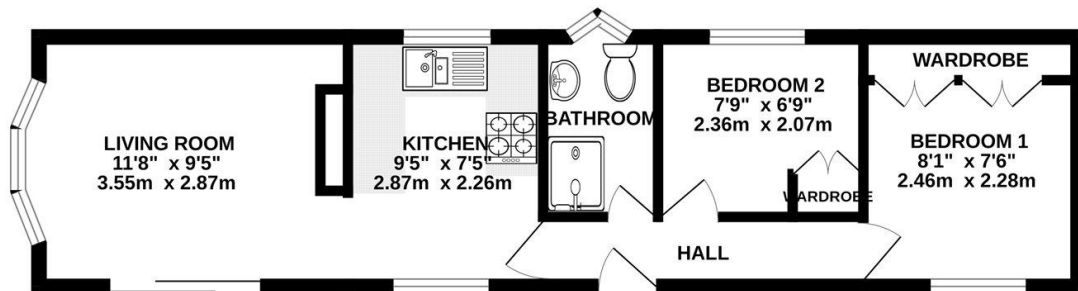

Whilst every attempt has been made to ensure the accuracy of the floorplan contained here, measurements of doors, windows, rooms and any other items are approximate and no responsibility is taken for any error, omission or mis-statement. This plan is for illustrative purposes only and should be used as such by any prospective purchaser. The services, systems and appliances shown have not been tested and no guarantee as to their operability or efficiency can be given.  
Made with Metropix ©2024



To arrange a viewing please contact:

Tel: 01252 361550

Email: [info@bridges.co.uk](mailto:info@bridges.co.uk)

Important Notice - These particulars are set out as a general outline only for the guidance of intended purchasers and do not form part of any offer or contract and must not be relied upon as statements or representations of fact. Purchasers must satisfy themselves by inspection or otherwise as to their correctness.