



Two Bedroom Apartment

Heathcote Road, Camberley, Surrey, GU15 2HU

Offers in the region of: £250,000

Leasehold

- Two Double Bedrooms
- Allocated Parking
- Communal Garden
- Long Lease
- Close to the Town Centre and Station
- Excellent Road Links
- Estimated Rental Price: £1,400 pcm
- EPC: C (80)



Description

This modern and stylish apartment boasts two spacious bedrooms, making it the perfect place to call home. Situated in a prime location, this property offers easy access to all amenities and transport links. The apartment is clean, well maintained, and secure, providing you with peace of mind. With a contemporary design and sleek finishes, the interior is both functional and aesthetically pleasing.

The property also features convenient parking facilities, ensuring that you always have a space for your vehicle. Whether you're a young professional looking for a trendy retreat or a small family in need of a comfortable home, this apartment ticks all the boxes.

Don't miss out on the opportunity to live in this fantastic property - contact us today for a viewing!

Outside

An allocated parking space is provided with this apartment, as well as a secure entry phone system and a primarily laid to lawn communal garden.

Floorplan

GROUND FLOOR

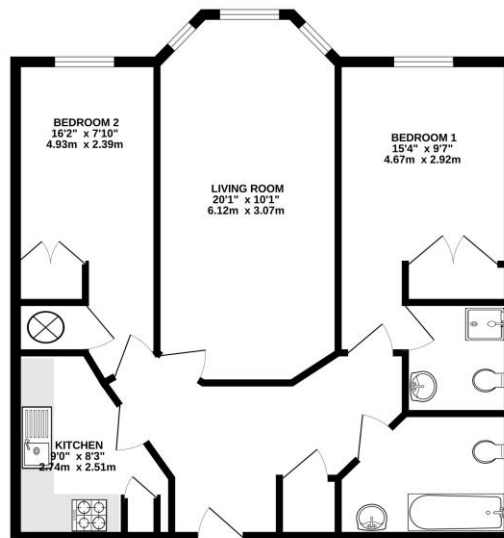

Whilst every attempt has been made to ensure the accuracy of the Supplier contained facts, measurements of doors, windows, rooms and any other items are approximate and no responsibility is taken for any error, omission or misstatement. This plan is for illustrative purposes only and should be used as a guide only. All dimensions are approximate and should be taken from the floor to ceiling and not guarantee. All to BMR specifications. In efficiency use for plan. Made with Hergo 02024



TO ARRANGE A VIEWING PLEASE CONTACT:

Tel: **01276 685544** or Email:
camberley@bridges.co.uk



Important Notice - These particulars are set out as a general outline only for the guidance of intended purchasers/tenants and do not form part of any offer or contract and must not be relied upon as statements or representations of fact. Purchasers/Tenants must satisfy themselves by inspection or otherwise as to their correctness.