

Two Bedroom Apartment

Montgomery Avenue, Wellesley, Aldershot, Hampshire, GU11 4DH

Price: £300,000

- Two Double Bedrooms
- Two Bathrooms
- Dual Aspect
- Kitchen with Integrated Appliances
- Two Allocated Parking Spaces
- Desirable Location
- Estimated Rental Price : £1,500 pcm
- EPC Rating: B (84)



Description

A simply stunning two bedroom apartment with numerous improvements made by the current owners. The accommodation comprises of two spacious double bedrooms with the principle benefitting from an en suite, a family bathroom, an open plan living/kitchen space and multiple storage units throughout. The property is situated on the second floor of Grieve House and further benefits from two allocated parking spots.

Outside

Two allocated parking spaces and situated close to local walking routes.

Floorplan

SECOND FLOOR

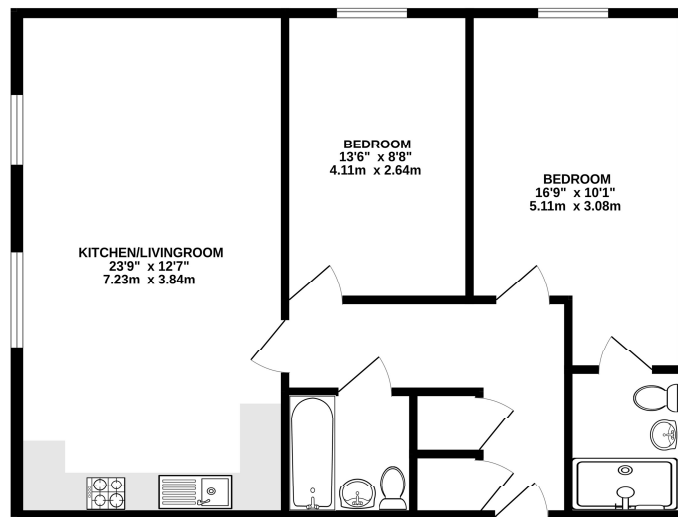

Whilst every attempt has been made to ensure the accuracy of the floorplans contained here, measurements of doors, windows, rooms and any other items are approximate and no responsibility is taken for any error, omission or mis-statement. This plan is for illustrative purposes only and should be used as such by any prospective purchaser. The services, systems and appliances shown have not been tested and no guarantee as to their operability or efficiency can be given.
Made with Metropix ©2018



To arrange a viewing please contact:

Tel: 01252 361550

Email: info@bridges.co.uk

Important Notice - These particulars are set out as a general outline only for the guidance of intended purchasers and do not form part of any offer or contract and must not be relied upon as statements or representations of fact. Purchasers must satisfy themselves by inspection or otherwise as to their correctness.