



One Double Bedroom Apartment

Farnborough Road, Farnborough, Hampshire, GU14 7GZ

Price: £230,000

- One Double Bedroom
- Modern Fitted Bathroom
- Ideal Investment or First Time Buy
- Allocated Parking
- No Onward Chain
- Close to the Town Centre
- Estimated Rental Price : £1,200 pcm
- EPC : D (65)



Description

A modern and well presented one double bedroom apartment in a highly sought after gated development in Farnborough. The apartment offers an open plan living space, a kitchen which has been finished to a high standard, a modern bathroom, and a double bedroom with built in storage. The property also benefits from an allocated parking bay in the secure underground car park. The apartment is ideal for anyone commuting due to its location, being within close proximity to Farnborough main train station which offers direct access to London Waterloo.

Outside

Externally, the development has some well presented communal garden spaces and the property benefits from an allocated parking space in the secure underground car park.

Floorplan

1ST FLOOR

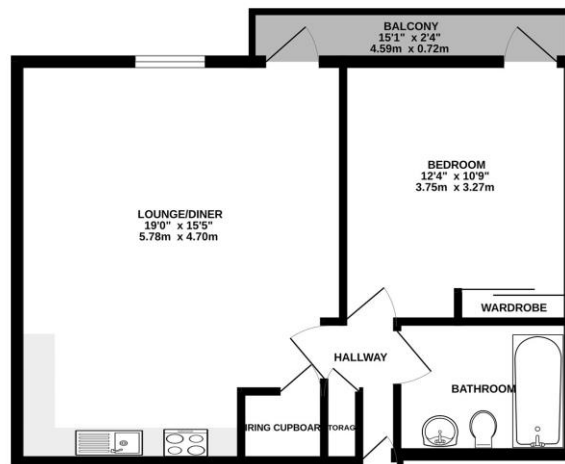

Whilst every attempt has been made to ensure the accuracy of the floorplan contained here, measurements of floors, ceilings, walls and other items are approximate and are intended to give a general impression of the dimensions. The floor is shown as a guide only and is not intended to be used as a guide for prospective purchasers. The services, systems and appliances shown have not been tested and are provided as a guide only. All measurements are in metres unless otherwise stated.

Bridges
.co.uk

the hub

To arrange a viewing please contact:

Tel: 01252 361550

Email: info@bridges.co.uk

Important Notice - These particulars are set out as a general outline only for the guidance of intended purchasers and do not form part of any offer or contract and must not be relied upon as statements or representations of fact. Purchasers must satisfy themselves by inspection or otherwise as to their correctness.