



Four Bedroom Detached House

Farleigh Wallop Drive, Fleet, Hampshire, GU51 1BQ

Price: £800,000

- Four Bedrooms
- Extended Detached Home
- Elvetham Heath
- Secluded Location
- Double Garage and Driveway
- No Onward Chain
- Viewing Advised
- EPC : D (68)



Description

Nestled in a secluded plot at the end of a cul-de-sac of just four houses sits this extended four bedroom detached family home, having been owned by the current vendor since new in 2000. The accommodation comprises an entrance hall with a covered porch, a living room, a cloakroom, a study/family room, and an extended kitchen/breakfast room with French doors to the garden. The first floor offers an extended principal bedroom with a walk in wardrobe and a four piece en suite bath/shower room, three further bedrooms, and a family bathroom. Other features to note include a south/westerly private rear garden, a gated driveway offering parking for multiple vehicles, and a detached double garage. Viewings are highly recommended.

Outside

The property offers a gated driveway with parking for multiple vehicles and access to the detached double garage via twin up and over doors. The garden is mainly laid to lawn with a patio seating area, and benefits from a south/westerly aspect.

Floorplan

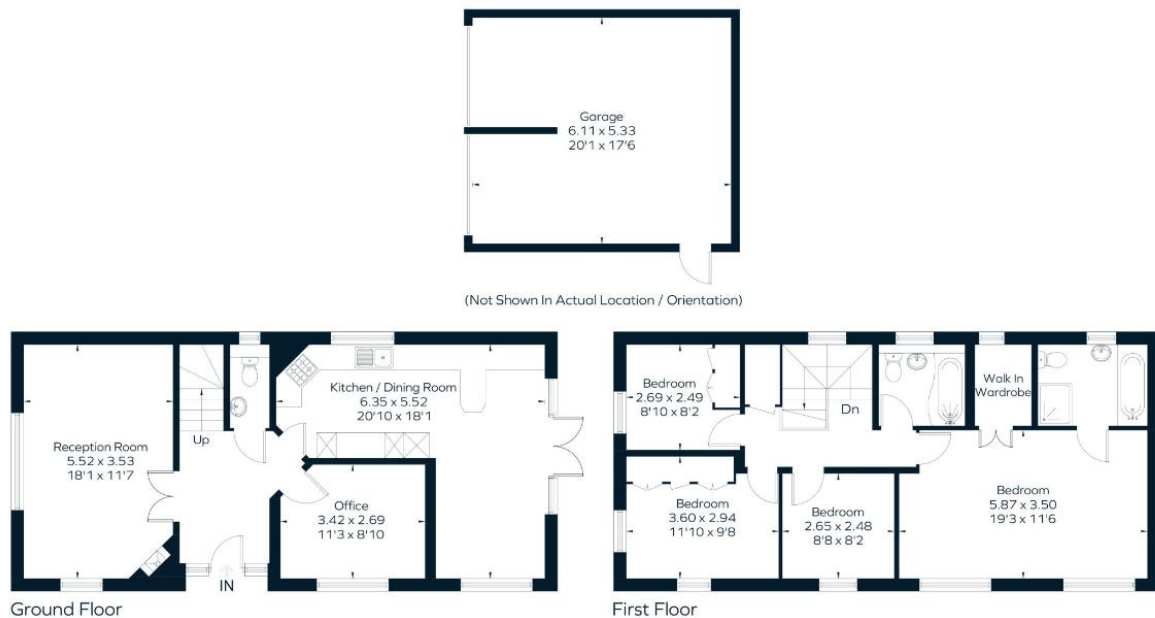

TO ARRANGE A VIEWING PLEASE CONTACT:
Tel: **01252 361550** or Email: info@bridges.co.uk



Important Notice - These particulars are set out as a general outline only for the guidance of intended purchasers/tenants and do not form part of any offer or contract and must not be relied upon as statements or representations of fact. Purchasers/Tenants must satisfy themselves by inspection or otherwise as to their correctness.