

Two Bedroom House

South Side, The Cardinals, Tongham, GU10 1EH

Offers in excess of: £375,000

- Two Double Bedrooms
- Extended
- Two Reception Rooms
- Well Presented Throughout
- Walking Distance to Amenities
- Tongham Village
- Landscaped Garden
- EPC: D (60)



Description

Located within the popular Tongham Village and within close walking distance of the local amenities is this immaculate two double bedroom, extended semi-detached home. The property downstairs boasts a spacious living room which flows nicely into the orangery, this space provides an ideal dining area with pleasant views out over the garden. Further downstairs accommodation includes a fitted kitchen that includes a side door out into the lean to and entrance porch. Upstairs boasts two good size double bedrooms, bedroom one includes built in wardrobes and there is also a family bathroom suite.

Outside

Outside boasts a landscaped private south facing rear garden with patio seating area, side access and a brick built storage shed.

Floorplan

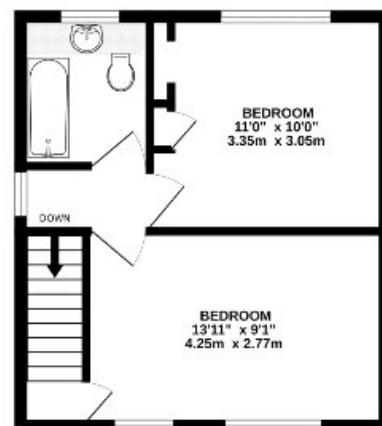
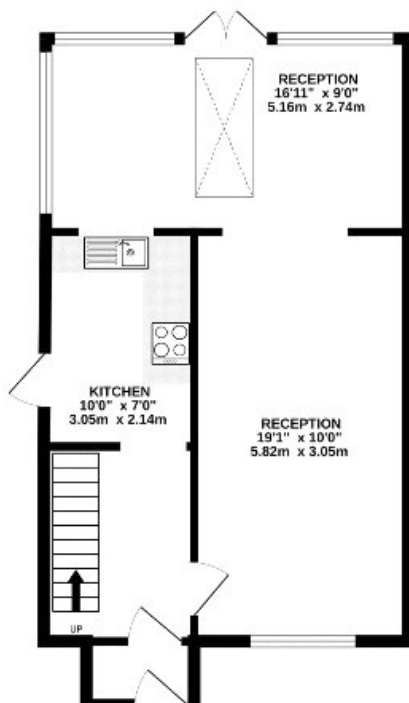

TO ARRANGE A VIEWING PLEASE CONTACT:
Tel: **01252 361550** or Email: **info@bridges.co.uk**



Important Notice - These particulars are set out as a general outline only for the guidance of intended purchasers/tenants and do not form part of any offer or contract and must not be relied upon as statements or representations of fact. Purchasers/Tenants must satisfy themselves by inspection or otherwise as to their correctness.