



Three Bedroom Semi-Detached Bungalow

Coleford Bridge Road, Mytchett, Camberley, Surrey, GU16 6DW

Guide Price: £500,000

- Three Double Bedrooms
- Semi-Detached Chalet/Bungalow
- Refitted En-Suite and Shower Room
- Refitted Kitchen
- Ample Driveway Parking
- Garage
- No Onward Chain
- EPC : TBC



Description

Offered to the market is this deceptively spacious three double bedroom semi-detached chalet bungalow located in a sought after location and within easy access of great commuter links. The property benefits from many improvements by the current owner and is offered to the market with no onward chain. The accommodation comprises of a 20' rear aspect living room with air conditioning, a separate dining room, refitted kitchen, two double bedrooms and a refitted shower room all to the ground floor. To the first floor you have another double bedroom with air conditioning and a refitted en suite bathroom. An internal inspection is highly recommended to truly appreciate all that this property has to offer.

Outside

Externally, the property benefits from a spacious plot comprising a mature enclosed rear garden that is mainly laid to lawn with a patio area and gated rear access to the nature reserve. To the front of the property, you have ample driveway parking leading down the side of the house to the detached garage.

Floorplan

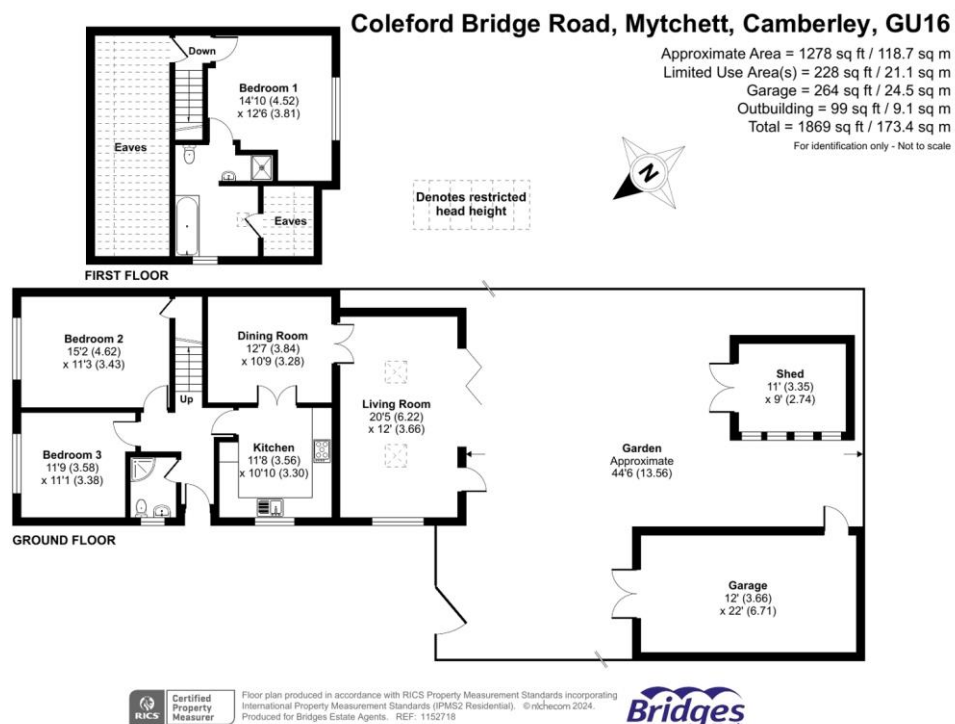

To arrange a viewing please contact:

Tel: 01252 361550

Email: info@bridges.co.uk

Important Notice - These particulars are set out as a general outline only for the guidance of intended purchasers and do not form part of any offer or contract and must not be relied upon as statements or representations of fact. Purchasers must satisfy themselves by inspection or otherwise as to their correctness.