

Three Bedroom Terraced House

Lydford Close, Farnborough, Hampshire, GU14 8UQ

Guide Price: £390,000

- Three Bedrooms
- Terraced House
- Recently Refurbished
- Private Rear Garden
- Driveway Parking
- Close to Local Amenities
- No Onward Chain
- EPC : D (68)



Description

Offered to the market, with no onward chain, is this recently refurbished three bedroom family home near Water Lane Park. To the ground floor there is a generously sized living room, a dining room, a kitchen leading out to a private rear garden and the property also offers a downstairs cloakroom. Upstairs there are three double bedrooms, and a three piece family bathroom. Viewings are highly recommended to appreciate the finish to this family home.

Outside

Externally, the property has a front courtyard style garden and an easily maintained rear garden with gated access and driveway parking.

Floorplan

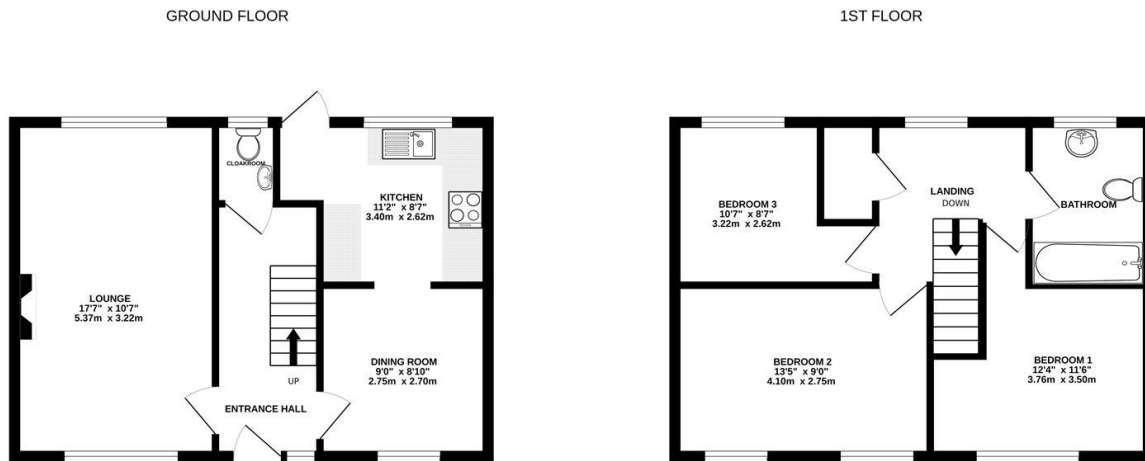

Whilst every attempt has been made to ensure the accuracy of the floorplan contained here, measurements of doors, windows, rooms and any other items are approximate and no responsibility is taken for any error, omission or mis-statement. This plan is for illustrative purposes only and should be used as such by any prospective purchaser. The services, systems and appliances shown have not been tested and no guarantee as to their operability or efficiency can be given.
Made with Metroplan ©2024



To arrange a viewing please contact:

Tel: 01252 361550

Email: info@bridges.co.uk

Important Notice - These particulars are set out as a general outline only for the guidance of intended purchasers and do not form part of any offer or contract and must not be relied upon as statements or representations of fact. Purchasers must satisfy themselves by inspection or otherwise as to their correctness.