

One Bedroom Ground Floor Apartment

John Norman Grove, Lightwater, Surrey, GU18 5AD

Offers in excess of: £200,000

- One Bedroom
- Ground Floor
- Allocated Parking
- Open Plan Kitchen/Living Room
- Well Presented Communal Grounds
- Ideal for First Time Buyers or Investors
- Heart of Lightwater Village
- EPC: C (77)



Description

Offered to the market with no onward chain and situated in the heart of Lightwater Village, a one bedroom ground floor apartment. The property benefits from an open plan living/kitchen space with French doors leading to the communal grounds, spacious bedroom with built in wardrobes and large bathroom.

Outside

Outside, there is allocated parking with multiple visitor parking spaces. The communal grounds are well presented and have washing line facilities.

Floorplan

GROUND FLOOR

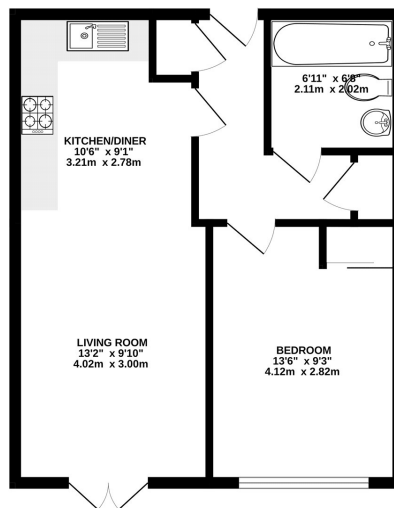

Whilst every attempt has been made to ensure the accuracy of the floorplan contained herein, measurements of doors, windows, stairs and any other items are approximate and no responsibility is taken for any error, omission or misstatement. This plan is for illustrative purposes only and should be used in conjunction with the prospective purchaser. The services, systems and appliances shown have not been tested and its purchase is to be made separately or otherwise as per plan.
Made with Metronix C2023



To arrange a viewing please contact:

Tel: 01252 361550

Email: info@bridges.co.uk

Important Notice - These particulars are set out as a general outline only for the guidance of intended purchasers and do not form part of any offer or contract and must not be relied upon as statements or representations of fact. Purchasers must satisfy themselves by inspection or otherwise as to their correctness.