



## Two Bedroom Apartment

**Birchett Road, Aldershot, Hampshire, GU11 1LY**

Offers in Excess of: £190,000

- Two Bedrooms
- Ground Floor
- Patio Doors
- Walking Distance to Aldershot Town Centre
- Allocated Parking
- Living/Dining Room
- No Onward Chain
- EPC : C (69)



## Description

This two bedroom ground floor apartment is offered to the market with no onward chain and in great condition. The accommodation boasts a good size lounge/diner, a fitted kitchen, a principal suite with a further bedroom and a family bathroom. The property further benefits from being walking distance to the town centre and mainline station to London Waterloo, secure intercom entry system and allocated resident parking.

## Outside

Allocated Parking.

## Floorplan

### GROUND FLOOR

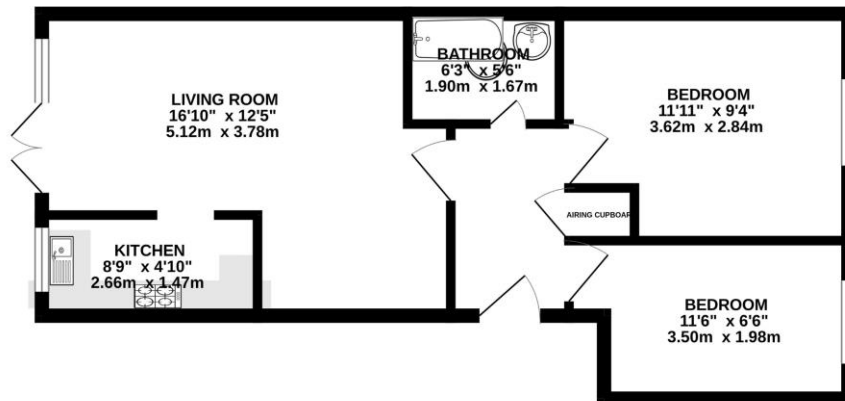

Whilst every attempt has been made to ensure the accuracy of the floorplan contained here, measurements of doors, windows, rooms and any other items are approximate and no responsibility is taken for any error, omission or mis-statement. This plan is for illustrative purposes only and should be used as such by any prospective purchaser. The services, systems and appliances shown have not been tested and no guarantee as to their operability or efficiency can be given.  
Made with Metropix ©2023



To arrange a viewing please contact:

Tel: 01252 361550

Email: [info@bridges.co.uk](mailto:info@bridges.co.uk)

Important Notice - These particulars are set out as a general outline only for the guidance of intended purchasers and do not form part of any offer or contract and must not be relied upon as statements or representations of fact. Purchasers must satisfy themselves by inspection or otherwise as to their correctness.