

Two Bedroom Ground Floor Apartment, Retirement Pinewood Court, Fleet, GU51 3BG

Offers in excess of: £100,000

- Two Bedrooms
- Ground Floor Apartment
- Bathroom
- Spacious Living Area
- Parking
- Close to Fleet High Street
- No Onward Chain
- EPC : E (53)



Description

Bridges are delighted to offer this two bedroom ground floor retirement apartment in Pinewood Court. Offered to the market with no onwards chain and a stone's throw from Fleet high street. The property is spacious, benefitting from two double bedrooms and a family bathroom. The main living area boasts patio doors, leading to the communal gardens, and leads through to the kitchen, with built in appliances.

Outside

Offered with communal parking, communal gardens and walking distance to Fleet high street.

Floorplan

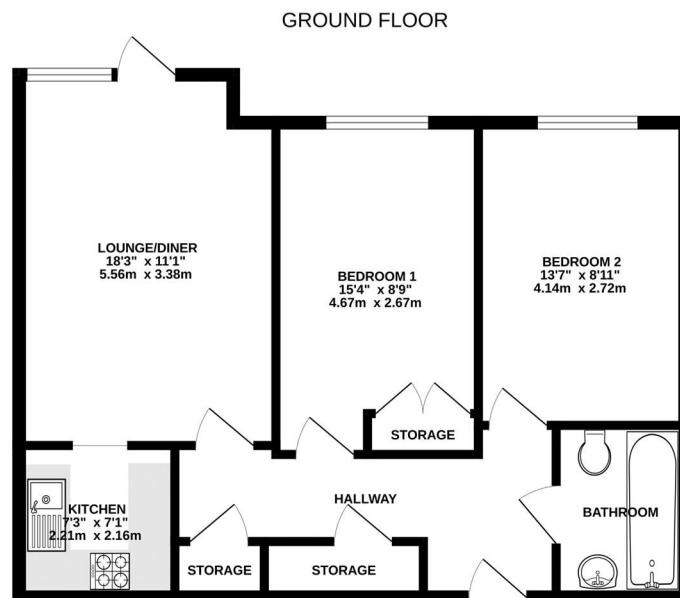

Whilst every attempt has been made to ensure the accuracy of the floorplan contained here, measurements of doors, windows, stairs and any other items are approximate and no responsibility is taken for any error, omission or mis-statement. This plan is for illustrative purposes only and should not be used as a basis for any prospective purchase. The services, systems and appliances shown have not been tested and no guarantee is given in their operation or efficiency save the green.
Made with Metropix C2024



To arrange a viewing please contact:

Tel: 01252 361550

Email: info@bridges.co.uk

Important Notice - These particulars are set out as a general outline only for the guidance of intended purchasers and do not form part of any offer or contract and must not be relied upon as statements or representations of fact. Purchasers must satisfy themselves by inspection or otherwise as to their correctness.