



One Bedroom Ground Floor Apartment Windsor Way, Aldershot, Hampshire, GU11 1HZ

Asking Price: £50,000

- One Bedroom
- Retirement Apartment
- McCarthy and Stone
- Close to Train and Bus Stations
- Communal Gardens
- Residents Parking
- Estimated Rental Price £950 pcm
- EPC: C (74)



Description

A ground floor one bedroom retirement apartment for the over 65's, built by McCarthy and Stone. Kingsley Court is ideally positioned for the train and bus stations and is close to the town. The property offers a large bedroom, 20'4 lounge/diner, four piece bathroom suite, 10'2 modern fitted kitchen with integrated appliances and is offered in good decorative order. Furthermore, there are communal grounds, residents lounge, guest suite and restaurant on site. This property has no onward chain and must be seen.

Outside

Area of communal grounds and residents parking.

Floorplan

GROUND FLOOR

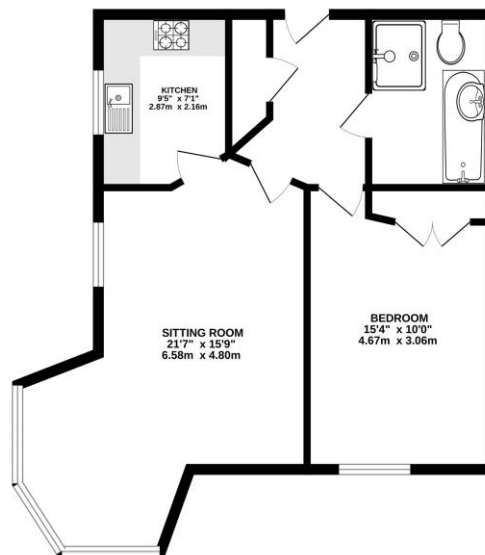

Whilst every attempt has been made to ensure the accuracy of the floorplan contained here, measurements of floor, window, door and any other feature are approximate and no responsibility is taken for any error, omission or misstatement. This plan is for illustrative purposes only and should be used as such by any prospective purchaser. The services, systems and equipment shown here are not tested and no guarantee as to their operability or efficiency can be given.
Issue with reference 12122



To arrange a viewing please contact:

Tel: 01252 361550

Email: info@bridges.co.uk

Important Notice - These particulars are set out as a general outline only for the guidance of intended purchasers and do not form part of any offer or contract and must not be relied upon as statements or representations of fact. Purchasers must satisfy themselves by inspection or otherwise as to their correctness.