

Two Bedroom Mobile Home

Grove Farm Park, Mytchett Road, Mytchett, GU16 6AQ

Asking Price: £110,000

- Two Bedrooms
- Mobile Home
- Utility Area
- Well Presented Throughout
- Private Enclosed Rear Garden
- Residents Parking
- Walking Distance to Local Amenities
- EPC: Exempt



Description

Offered to the market is this well presented two-bedroom mobile home. The property is within walking distance to the local amenities, is only a short drive to the railway stations and also offers easy access onto the M3. There is the Ranges and Canal nearby which offer beautiful walks through some of the nearby nature. The mobile home boasts two bedrooms, a bathroom, reception area, utility room and a kitchen.

Outside

Outside boasts parking and an attractive private garden.

Floorplan

GROUND FLOOR

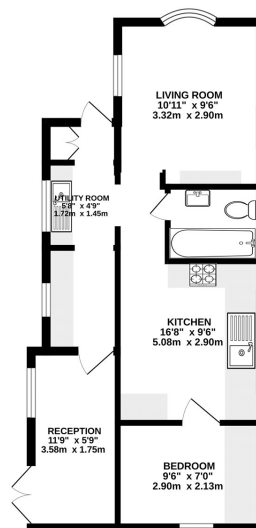

Whilst every attempt has been made to ensure the accuracy of the floorplan contained herein, measurements of doors, windows, stairs and any other items are approximate and are not intended to be used for any purpose other than as a guide only. The floor plan is for illustrative purposes only and should be used in conjunction with the property particulars. The services, systems and appliances shown have not been tested and no guarantee can be made regarding their operation or condition.

Made with Metreplan C2023



To arrange a viewing please contact:

Tel: 01252 361550

Email: info@bridges.co.uk

Important Notice - These particulars are set out as a general outline only for the guidance of intended purchasers and do not form part of any offer or contract and must not be relied upon as statements or representations of fact. Purchasers must satisfy themselves by inspection or otherwise as to their correctness.