



Two Bedroom Apartment

Lampton Road, Hounslow, TW3 4DF

Offers in excess of: £270,000

- Two Bedrooms
- Investment Only
- Generously Sized Lounge
- Fitted Kitchen
- Double Glazing and Gas Central Heating
- Three Piece Bathroom
- Allocated Parking
- EPC : C (80)



Description

INVESTMENT ONLY Bridges Estate Agents are delighted to offer this well presented two bedroom second floor flat which is situated in a very popular residential location due to having easy access to Hounslow Central station and easy access to Great West Road, the M4/M25 motorway network and London Heathrow Airport.

This clean and tidy property features an entrance hall, lounge area, dining area, modern fitted kitchen and family bathroom.

In addition to this, this property offers double glazed windows and residential parking.

Outside

Externally, the property benefits from well kept communal gardens.

Floorplan

GROUND FLOOR

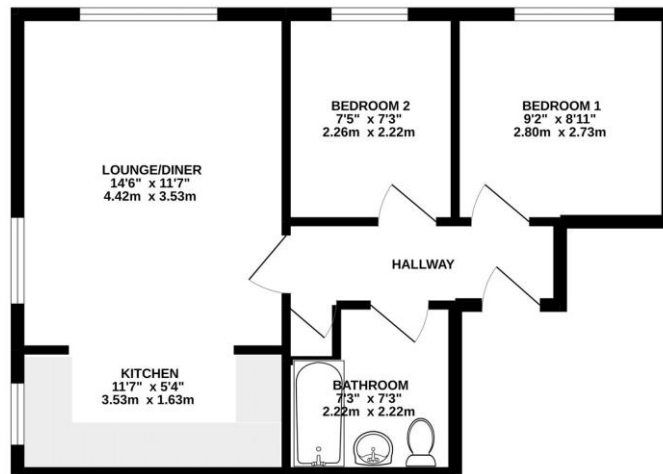

While every attempt has been made to ensure the accuracy of the floorplan contained herein, measurements of doors, windows, rooms and any other items are approximate and no responsibility is taken for any error, omission or mis-statement. This plan is for illustrative purposes only and should be used as such by any prospective purchaser. The services, systems and appliances shown have not been tested and no guarantee as to their operability or efficiency can be given. Made with Metropix 10002



TO ARRANGE A VIEWING PLEASE CONTACT:
Tel: **01252 361550** or Email: **info@bridges.co.uk**



Important Notice - These particulars are set out as a general outline only for the guidance of intended purchasers/tenants and do not form part of any offer or contract and must not be relied upon as statements or representations of fact. Purchasers/Tenants must satisfy themselves by inspection or otherwise as to their correctness.