



## Two Bedroom Bungalow

**Lemon Grove, Whitehill, Bordon, Hampshire, GU35 9BE**

Price: £325,000

- Two Double Bedrooms
- Bungalow
- Desirable Location
- No Onward Chain
- Recently Renovated
- Driveway/Garage
- Low Maintenance Garden
- EPC : C (71)



## Description

Available to the market with no onward chain is this delightful two bedroom bungalow, situated within a popular cul-de-sac location. Having been much improved by the current owner this property offers the very best of contemporary living. The accommodation comprises two double bedrooms, a recently refitted kitchen with an eye level oven and units, and an attractive lounge that in turn leads into an extended garden/dining room. In addition, there is a three piece family bathroom suite, cleverly designed and boasting natural light entering from a light tunnel.

## Outside

To the front of this impressive bungalow is a driveway for multiple vehicles. The rear garden is low maintenance and well presented, mostly paved and offers access to a garage.

## Floorplan

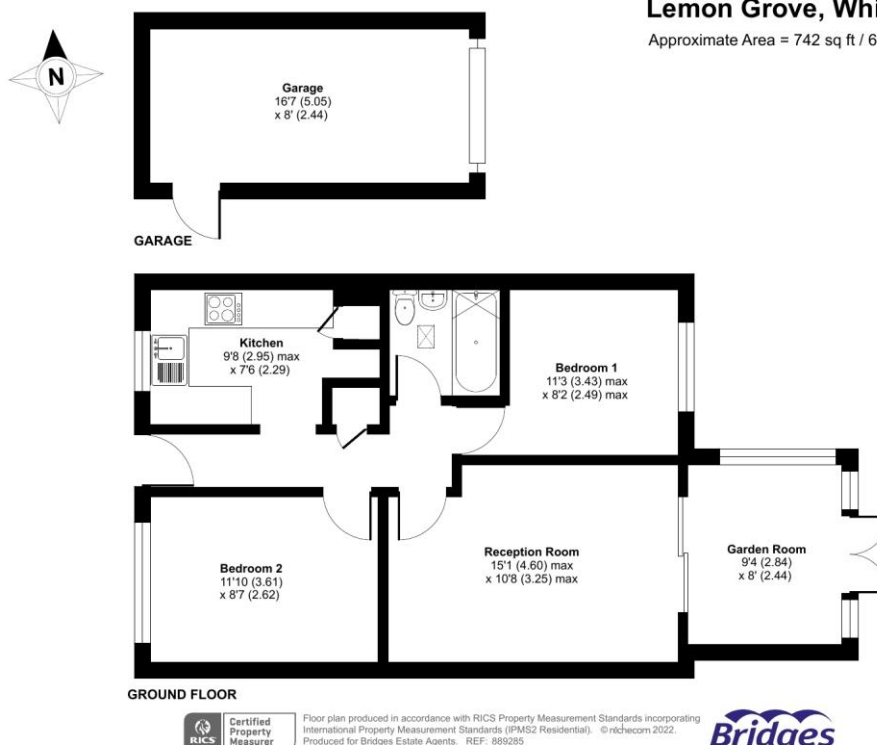

**TO ARRANGE A VIEWING PLEASE CONTACT:**  
Tel: **01252 361550** or Email: **info@bridges.co.uk**



Important Notice - These particulars are set out as a general outline only for the guidance of intended purchasers/tenants and do not form part of any offer or contract and must not be relied upon as statements or representations of fact. Purchasers/Tenants must satisfy themselves by inspection or otherwise as to their correctness.