



Two Bedroom Apartment

Birchett Road, Aldershot, Hampshire, GU11 1FB

Guide Price: £210,000

- Two Bedrooms
- High Specification Apartment
- Gloss White Optiplan Kitchens
- Integrated Appliances
- Contemporary Bathrooms
- No Onward Chain
- Estimated Rental Price: £1,250pcm
- EPC: D (56)



Description

Situated in the heart of Aldershot town centre and within close proximity to the mainline station, this beautifully presented first floor apartment is offered with no chain complications. This particular apartment was the ex show home apartment and, as such, offers spacious accommodation and plenty of natural light. Accommodation comprises a dual aspect reception room/kitchen with integrated appliances, two double bedrooms with built in wardrobes, an en suite shower room and a further bathroom. The property is approached via secure electric gates to the car parking, there is a security entry phone system and allocated parking. **DISCLAIMER:** the marketing photos were taken prior to the current tenants occupying the property.

Outside

This property offers parking facilities.

Floorplan

GROUND FLOOR

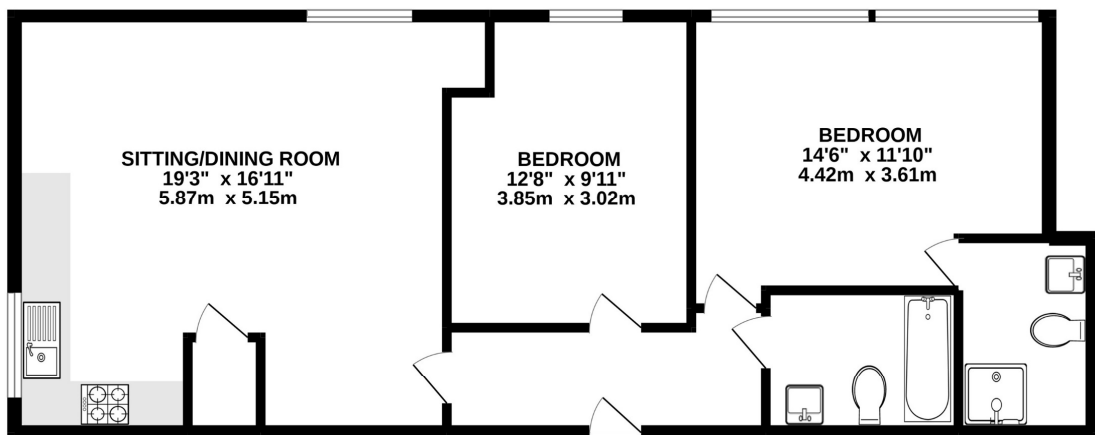

Whilst every attempt has been made to ensure the accuracy of the floorplan contained here, measurements of doors, windows, rooms and any other items are approximate and no responsibility is taken for any error, omission or mis-statement. This plan is for illustrative purposes only and should be used as such by any prospective purchaser. The services, systems and appliances shown have not been tested and no guarantee as to their operability or efficiency can be given.
Made with Metropix ©2022



To arrange a viewing please contact:

Tel: 01252 361550

Email: info@bridges.co.uk

Important Notice - These particulars are set out as a general outline only for the guidance of intended purchasers and do not form part of any offer or contract and must not be relied upon as statements or representations of fact. Purchasers must satisfy themselves by inspection or otherwise as to their correctness.