

Two Bedroom Apartment

Tudor Hall, Branksome Park Road, Camberley, Surrey, GU15 2AE

Guide Price: £300,000

- Ground Floor Maisonette
- Two Double Bedrooms
- Modern Kitchen
- Open Plan Living Room
- Character Features
- Attractive Communal Gardens
- Share of Freehold
- EPC: D (65)



Description

A delightful ground floor maisonette, located in a stunning period property in Camberley, providing convenient access to the towns comprehensive amenities and boasting a share of the freehold. The property enjoys an attractive mix of original features, including high ceilings and traditional windows, with contemporary modern upgrades, incorporating an open plan living room and kitchen. There are two generous double bedrooms, a refitted white three piece bathroom, landscaped communal grounds, its own front door and ample visitors` parking.

Outside

There is substantial parking for residents and large communal gardens, which are mainly laid to lawn, surrounded and secluded by mature trees and shrubs.

Floorplan

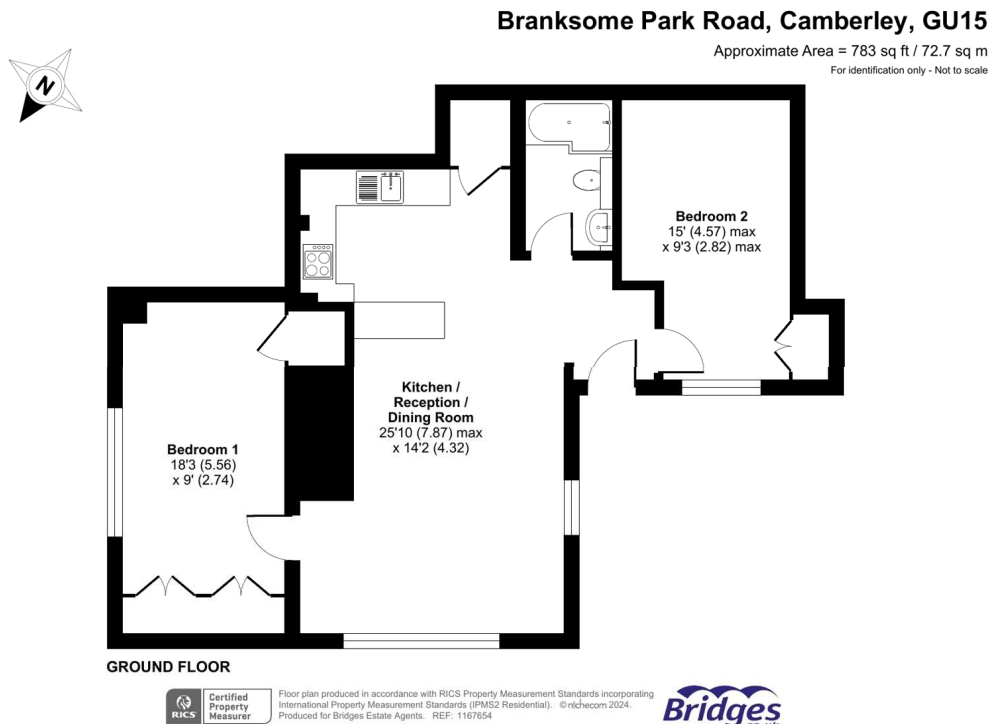

To arrange a viewing please contact:

Tel: 01252 361550

Email: info@bridges.co.uk

Important Notice - These particulars are set out as a general outline only for the guidance of intended purchasers and do not form part of any offer or contract and must not be relied upon as statements or representations of fact. Purchasers must satisfy themselves by inspection or otherwise as to their correctness.