



Four Bedroom Detached House

Southcote Park, Camberley, Surrey, GU15 1JP

Price: £600,000

- Four Bedrooms
- Detached Home
- New Windows and Front Door
- Refitted Kitchen
- Separate Living/Dining/Family Room
- Driveway and a Garage
- Close to Local Schools
- EPC : C (75)



Description

Positioned within this cul-de-sac location stands this impressive four bedroom link detached house built by Laing Homes to the Hampton Plus design. The property is ideally situated within close proximity to Prior Heath, Ravenscote and Tomlinscote schools. Arranged over three floors, the accommodation comprises an open plan living room, dining room, family room and a refitted kitchen/breakfast room. On the first floor there is a principal bedroom with a walk in wardrobe and en suite bathroom, two further double bedrooms, and a refitted family bathroom. On the second floor there is a generously sized double bedroom with Velux windows which could also be utilised as a fourth reception room.

Outside

There is a driveway and a garage to the front of the home. The rear garden is enclosed and mainly laid to lawn with a patio area immediately to the rear, making it the ideal space for al fresco dining.

Floorplan

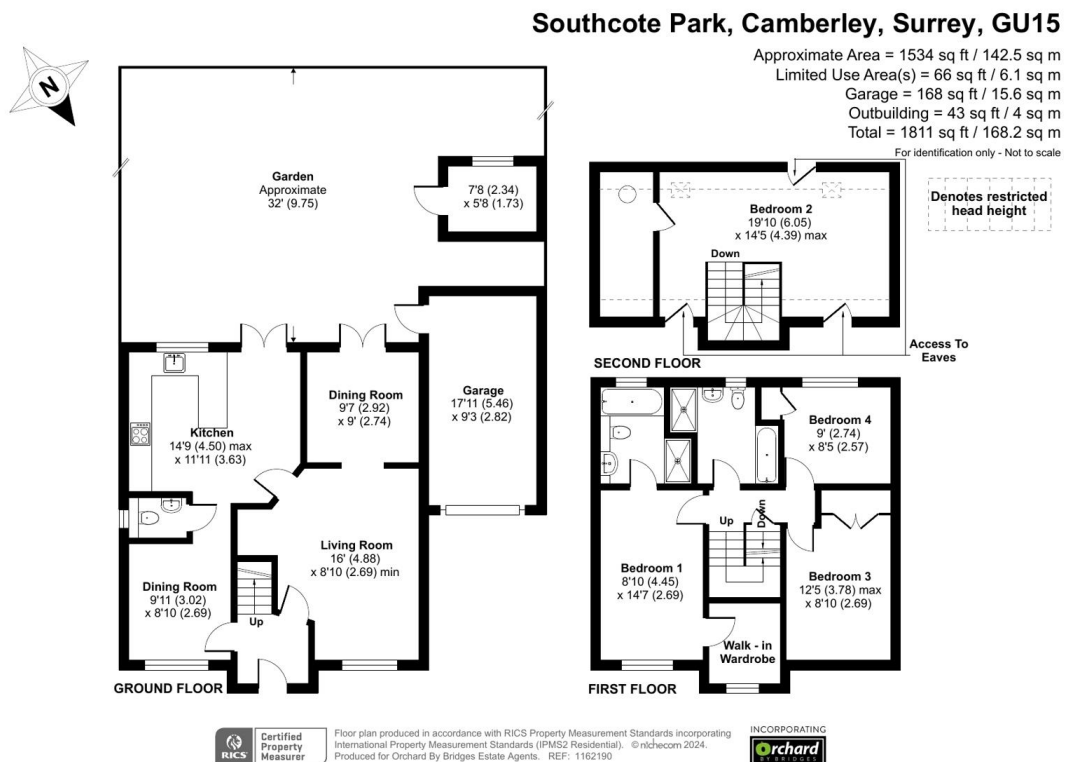

TO ARRANGE A VIEWING PLEASE CONTACT:

Tel: **01276 685544** or Email:
camberley@bridges.co.uk



Important Notice - These particulars are set out as a general outline only for the guidance of intended purchasers/tenants and do not form part of any offer or contract and must not be relied upon as statements or representations of fact. Purchasers/Tenants must satisfy themselves by inspection or otherwise as to their correctness.