

Two Bedroom Detached Mobile Home

The Willows Park, Guildford Road, Normandy, GU3 2BJ

Offers in excess of: £100,000

- Two Bedrooms
- Park Home
- Wrap Around Garden
- Well Maintained Site
- Rural Location
- Convenient Location Close to Guildford
- Must Be Seen
- Popular Development



Description

Offered to market is this delightful two-bedroom double unit park home for the over 50's, set within the popular Surrey Hills Park, the property has two bedrooms, a generous open plan lounge/diner leading to a spacious kitchen, there is also a shower room/wet room. The site is located conveniently between Guildford and Ash Vale, with good bus connections both ways, whilst also being a very rural location.

Outside

The property has an allocated parking space, and a private garden that wraps around the property, mostly patio area however there is also a small area of lawn. There are also some lovely places to walk nearby.

Floorplan

GROUND FLOOR

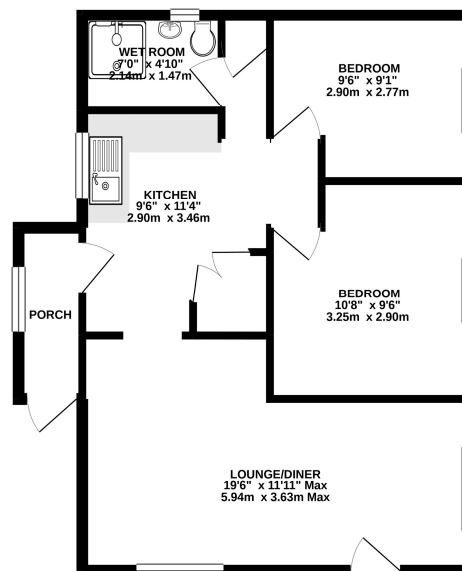

While every attempt has been made to ensure the accuracy of the floorplan contained here, measurements of doors, windows, stairs and any other items are approximate and no responsibility is taken for any error, omission or mis-statement. This plan is for illustrative purposes only and should be used as such by any prospective purchaser. The services, products and appliances shown have not been tested and no guarantee is given for their availability or suitability. Made with Metrage 6.0.021



To arrange a viewing please contact:

Tel: 01252 361550

Email: info@bridges.co.uk

Important Notice - These particulars are set out as a general outline only for the guidance of intended purchasers and do not form part of any offer or contract and must not be relied upon as statements or representations of fact. Purchasers must satisfy themselves by inspection or otherwise as to their correctness.