



Four Bedroom Detached House Stoneleigh Court, Frimley, GU16 8XH

Guide Price: £625,000

- Four Bedrooms
- Two Reception Rooms
- Refitted Luxury Kitchen
- Popular Paddock Hill Development
- En Suite Shower Room to Principal Bedroom
- Corner Plot
- South Westerly Rear Garden
- EPC: D (67)



Description

A beautifully presented extended four bedroom detached family home, situated on the ever so popular Paddock Hill Development. The property has been skilfully extended by the current owners and boasts an entrance hall, refitted downstairs cloakroom, spacious living room with French doors, dining room, refitted luxury kitchen and utility room to the ground floor. Upstairs offers three double bedrooms with the principal bedroom benefitting from an en suite shower room, single bedroom and a family bathroom. Being situated within a lovely cul-de-sac location, being close to all local amenities and being within the catchment area for the sought after Tomlinscote secondary school. Viewings are highly recommended and strictly by appointment only.

Outside

Externally there is driveway parking for multiple vehicles along with a single garage. To the rear is a South Westerly facing garden which enjoys lots of direct sunshine. The garden is mainly laid to lawn along with an area of patio perfect for outside entertaining and alfresco dining.

Floorplan

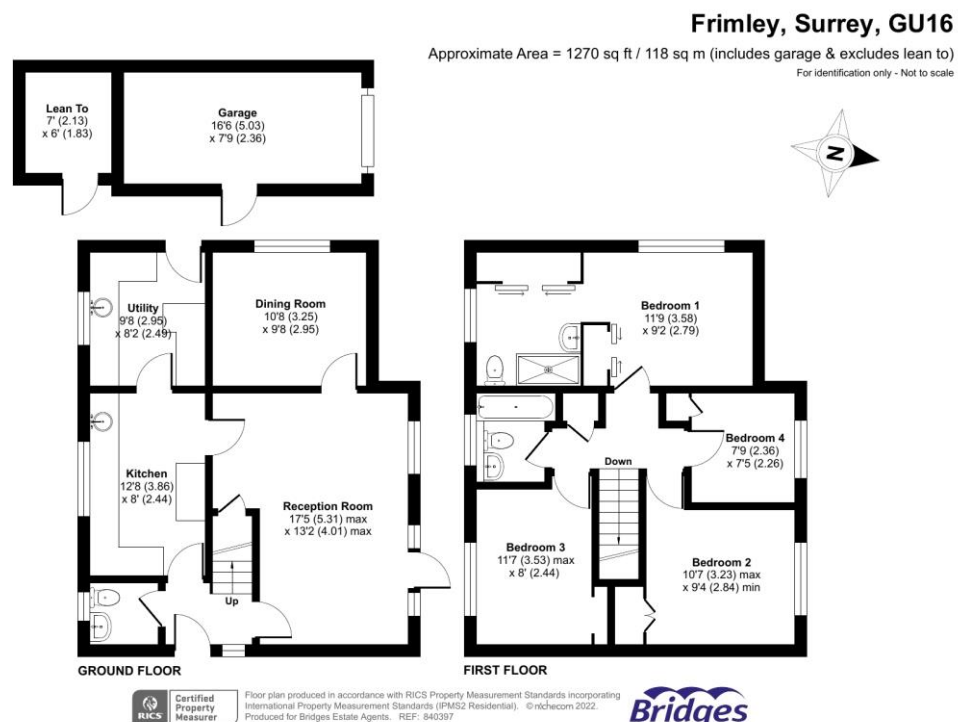

To arrange a viewing please contact:

Tel: 01252 361550

Email: info@bridges.co.uk

Important Notice - These particulars are set out as a general outline only for the guidance of intended purchasers and do not form part of any offer or contract and must not be relied upon as statements or representations of fact. Purchasers must satisfy themselves by inspection or otherwise as to their correctness.