



## Two Bedroom Apartment

**Beverley House, Wallis Square, Farnborough, GU14 7GR**

Guide Price: £237,500

- Two Bedrooms
- Lounge
- Family Bathroom and En Suite
- Modern Fitted Kitchen
- Fitted Appliances
- Easy Access to the Town and Train Station
- Estimated Rental Price : £1,400 pcm
- EPC : C (69)



## Description

Bridges Estate Agents are delighted to offer this two double bedroom apartment with no onward chain, situated in the heart of Farnborough town centre and close to Farnborough train station which has links to London Waterloo in under 40 minutes.

This property is well sized as it is bigger than the average apartment in the development. Internally the accommodation comprises of an open plan kitchen/living room, two double bedrooms with the main bedroom benefiting from an en suite shower room and built in wardrobes, and lastly a three piece family bathroom suite. This property would be perfect for first time buyers or an investor looking for a great investment opportunity.

## Outside

Outside, there are well kept communal gardens and underground parking.

## Floorplan

GROUND FLOOR

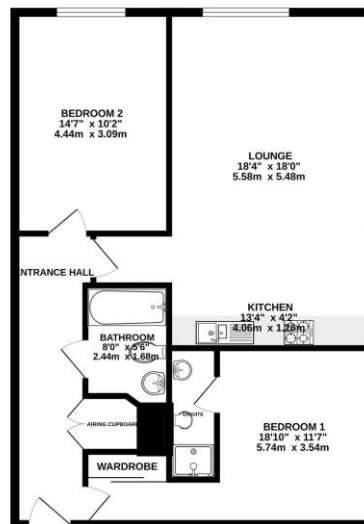

While every attempt has been made to ensure the accuracy of the floorplan contained herein, measurements of floors, walls, doors and any other items are approximate and no responsibility is taken for any errors or omissions in the drawings. The actual floorplan is available for inspection only and should be used only as a guide to the general layout. The fixtures, fittings and appliances shown have not been measured and are guaranteed only when specified in writing by the agent.  
Made with Design-CAD2000



To arrange a viewing please contact:

Tel: 01252 361550

Email: [info@bridges.co.uk](mailto:info@bridges.co.uk)

Important Notice - These particulars are set out as a general outline only for the guidance of intended purchasers and do not form part of any offer or contract and must not be relied upon as statements or representations of fact. Purchasers must satisfy themselves by inspection or otherwise as to their correctness.