



Three Bedroom Detached House

Sandy Lane, Farnborough, Hampshire, GU14 9JD

Guide Price: £480,000

- Three Bedrooms
- Detached Family Home
- Modern Kitchen
- En Suite Shower Room
- Garage and Driveway Parking
- Good Sized Rear Garden
- Popular Non Estate Location
- EPC : C (76)



Description

Available to the market is this modern three bedroom detached family home, situated in a popular non estate location within close proximity and easy access of local schools and shops, including the local Co-Operative. The property benefits from a downstairs cloakroom, a good sized lounge with double doors leading to the well presented garden, a modern kitchen/diner, an en suite shower room to the principle bedroom and a family bathroom. This home is well presented throughout and we highly recommend coming to view!

Outside

Externally, the property provides you with driveway parking, a good sized enclosed garden and a garage, also with gated entry to the front. The property also benefits from being a short walk away from the local Co-Operative, as well as being close to local schools of all ages.

Floorplan

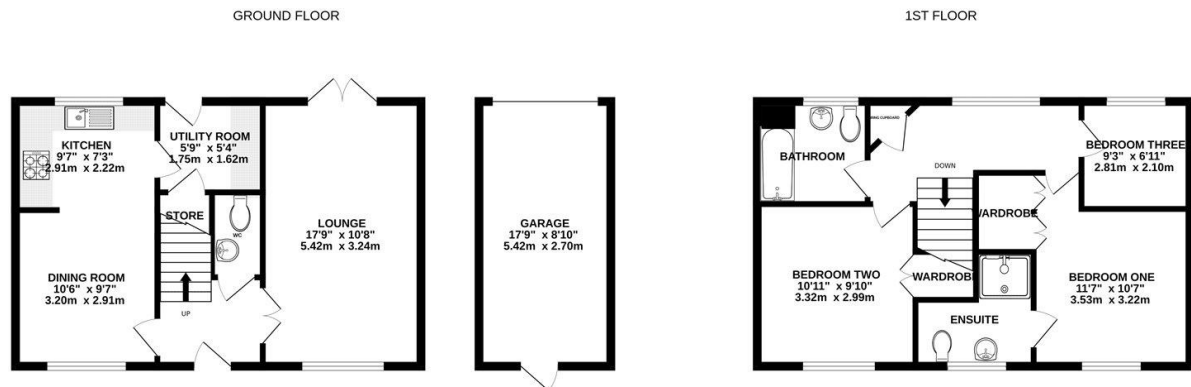

Whilst every attempt has been made to ensure the accuracy of the floorplan contained here, measurements of doors, windows, rooms and any other items are approximate and no responsibility is taken for any error, omission or mis-statement. This plan is for illustrative purposes only and should be used as such by any prospective purchaser. The services, systems and appliances shown have not been tested and no guarantee as to their operability or efficiency can be given.
Made with Metropix ©2023



To arrange a viewing please contact:

Tel: 01252 361550

Email: info@bridges.co.uk

Important Notice - These particulars are set out as a general outline only for the guidance of intended purchasers and do not form part of any offer or contract and must not be relied upon as statements or representations of fact. Purchasers must satisfy themselves by inspection or otherwise as to their correctness.