



Four Bedroom Detached House

Oaklea, Ash Vale, Surrey, GU12 5HP

Offers in excess of: £480,000

- Four Double Bedrooms
- Detached Family Home
- Refitted Kitchen
- Two Receptions Rooms
- Conservatory
- Driveway and Garage
- Sought after Cul-de-Sac
- EPC: D (62)



Description

A four double bedroom detached family home located in this highly sought after cul-de-sac in Ash Vale Village. Well presented throughout this great home really has a lot to offer any family looking to enjoy village lifestyle. With a refitted kitchen, two reception rooms and a conservatory the living accommodation is awesome. There is also a downstairs cloakroom and handy utility room. Upstairs are four double bedrooms and a refitted family bathroom. The house has a good sized driveway with parking for several vehicles and a garage, the rear garden is also nice and private. This cul-de-sac is desirable because not only is it close to Ash Vale mainline station but also the highly sought after Holly Lodge school and the Basingstoke Canal. Call us today to come and see this brilliant home.

Outside

To the front is a driveway with parking for multiple vehicles and a lawn. To the rear is a generous garden with patio area perfect for outside entertaining and a lawn section all enclosed by wood panel fencing.

Floorplan

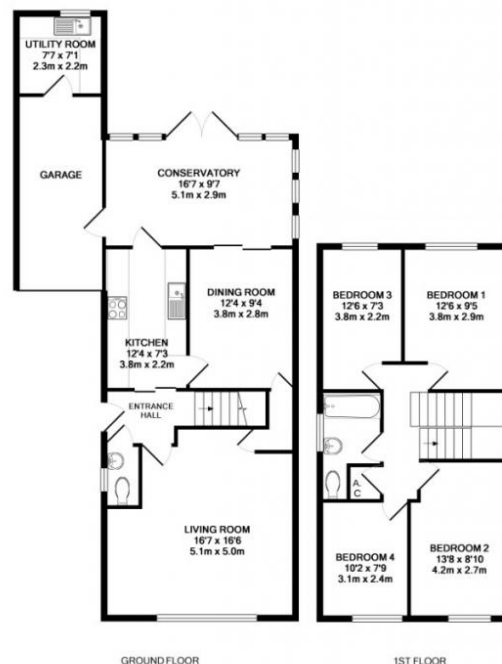

Whilst every attempt has been made to ensure the accuracy of the floor plan contained here, measurements of doors, windows, rooms and any other items are approximate and no responsibility is taken for any error, omission, or mis-statement. This plan is for illustrative purposes only and should be used as such by any prospective purchaser. The services, systems and appliances shown have not been tested and no guarantee as to their operability or efficiency can be given.
Made with Metropix i2019



To arrange a viewing please contact:

Tel: 01252 361550

Email: info@bridges.co.uk

Important Notice - These particulars are set out as a general outline only for the guidance of intended purchasers and do not form part of any offer or contract and must not be relied upon as statements or representations of fact. Purchasers must satisfy themselves by inspection or otherwise as to their correctness.