

One Bedroom Apartment

Brackendale Close, Camberley, Surrey, GU15 1HP

Guide Price: £180,000

- Double Bedroom
- Front Aspect Living
- Refitted Kitchen
- Three Piece Bathroom
- Modern Electric Heating
- Communal Residents` Gardens
- Allocated Parking Space
- EPC : E (45)



Description

A first floor character conversion apartment, making an ideal first time buy or investment. Located on a desirable residential road, close to major road links, Frimley Park Hospital and the train station. One can find an entrance hall, three piece bathroom, double bedroom, open plan living room/refitted kitchen with bay window. There are high ceilings, well maintained communal lawned gardens, with storage shed as well as allocated and visitor parking.

Outside

Communal grounds with allocated parking bay and visitors parking area.

Floorplan

GROUND FLOOR

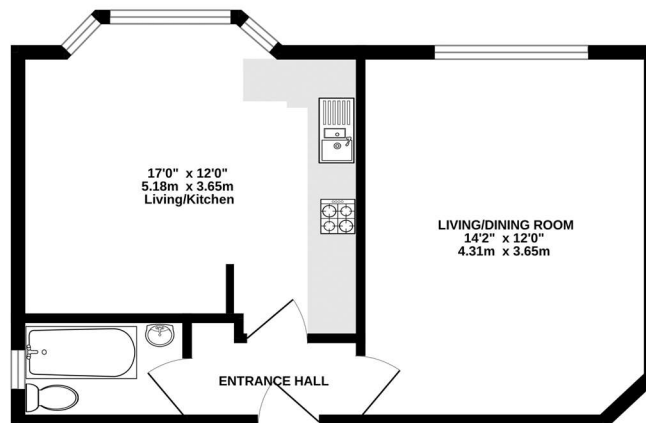

Whilst every attempt has been made to ensure the accuracy of the floorplan contained here, measurements of doors, windows, rooms and any other items are approximate and no responsibility is taken for any error, omission or mis-statement. This plan is for illustrative purposes only and should be used as such by any prospective purchaser. The services, systems and appliances shown have not been tested and no guarantee as to their operability or efficiency can be given.
Made with Metropix 02024



To arrange a viewing please contact:

Tel: 01252 361550

Email: info@bridges.co.uk

Important Notice - These particulars are set out as a general outline only for the guidance of intended purchasers and do not form part of any offer or contract and must not be relied upon as statements or representations of fact. Purchasers must satisfy themselves by inspection or otherwise as to their correctness.