



Two Bedroom Apartment

Horseshoe Crescent, Camberley, Surrey, GU15 4DS

Offers in excess of: £190,000

Leasehold

- Two Bedrooms
- Refitted Kitchen
- Refurbished Lounge/Diner
- Secure Entry Phone System
- In Catchment for Outstanding Schools
- Close to Local Amenities
- Estimated Rental Price : £1,250 pcm
- EPC: D (62)



Description

Introducing this modern two bedroom apartment! Situated in a quiet and secluded location, this property offers a peaceful retreat in a convenient setting. The apartment is clean and spacious, and is an ideal home for first time buyers, young professionals, or investors.

The accommodation includes a spacious living room, separate refitted kitchen, two bedrooms and a three- piece bathroom suite. Further benefits include double glazing, gas central heating, a security entry phone system and a generous storage cupboard.

This well presented two double bedroom top floor apartment is located within the Old Dean development in Camberley, within a short walk to Swinley Forest and Camberley town centre is close by, featuring The Atrium shopping centre and an array of restaurants and leisure facilities. Don't miss the opportunity to own this fantastic property that ticks all the boxes for modern living. Contact us today to arrange a viewing and secure your new home!

Outside

There is ample parking to the front of the apartment.

The apartment boasts communal gardens.

Floorplan

TOP FLOOR

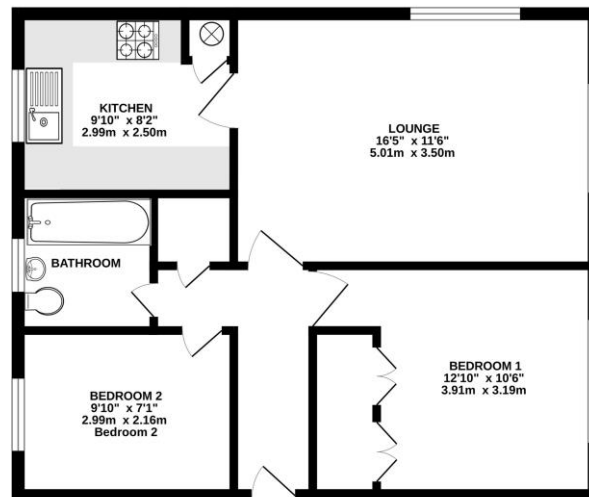

While every attempt has been made to ensure the accuracy of the floorplan contained here, measurements of doors, windows, rooms and any other items are approximate and no responsibility is taken for any error, omission or mis-statement. This plan is for guidance purposes only and should be used for your own information only. The seller, agent and developer make no representation or warranty as to their accuracy or efficiency and no guarantee is given. Please visit www.bridges.co.uk



TO ARRANGE A VIEWING PLEASE CONTACT:

Tel: **01276 685544** or Email:

camberley@bridges.co.uk



Important Notice - These particulars are set out as a general outline only for the guidance of intended purchasers/tenants and do not form part of any offer or contract and must not be relied upon as statements or representations of fact. Purchasers/Tenants must satisfy themselves by inspection or otherwise as to their correctness.