



Two Double Bedroom Apartment

Queensmead, Farnborough, Hampshire, GU14 7GN

Price: £250,000

- Two Double Bedrooms
- Above Commercial Apartment
- Two Bathrooms
- Private Balcony
- Allocated Parking
- No Onward Chain
- Estimated Rental Price : £1,250 pcm
- EPC : B (83)



Description

Bridges are delighted to share with you this well presented two double bedroom apartment situated in Farnborough town centre. This property offers a modern open plan kitchen/living/dining room leading to a great sized private balcony. There are also two double bedrooms with the principal bedroom benefitting from an en suite shower room. Further benefits of this property comprise the allocated parking, a communal lift, and a roof top garden. Lastly, the apartment is positioned in an ultra convenient town centre location with great commuting links to London Waterloo. Viewings are highly recommended!

Outside

Externally, the apartment offered a great sized balcony, and a communal rooftop garden. Additionally, the apartment also provides allocated parking.

Floorplan

GROUND FLOOR

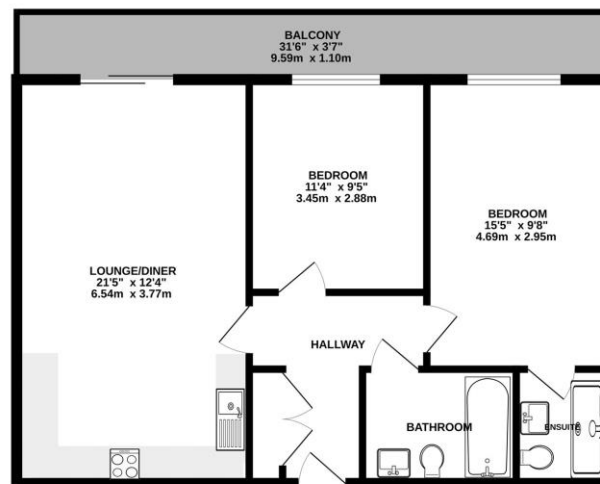

Whilst every attempt has been made to ensure the accuracy of the floorplan contained here, measurements of floors, ceilings, rooms and any other parts are approximate and no responsibility is taken for any error, omission or misstatement. This plan is a guide only and should not be relied upon for any legal or financial purposes. The services, systems and appliances shown have not been tested and no guarantee is made for their availability or efficiency on the ground.
Made with Mettler CC204



To arrange a viewing please contact:

Tel: 01252 361550

Email: info@bridges.co.uk

Important Notice - These particulars are set out as a general outline only for the guidance of intended purchasers and do not form part of any offer or contract and must not be relied upon as statements or representations of fact. Purchasers must satisfy themselves by inspection or otherwise as to their correctness.