



## Two Bedroom Park Home

**Brookside Park, Hawley Lane, Farnborough, Hampshire, GU14 9AZ**

Guide Price: £169,500

- Two Bedrooms
- Park Home
- Low Maintenance Garden
- Updated and Improved Insulation
- Popular Brookside Park
- Close to Amenities
- Driveway Parking
- EPC: TBC



## Description

Offered for sale in good decorative order throughout, this charming park home is located on the popular Brookside Park development, conveniently close to shops and major road links. The property boasts generously sized accommodation, including a comfortable lounge/diner featuring a cozy electric burner. The fitted kitchen provides ample space for a fridge/freezer, while the modern three-piece bathroom serves the home. There are two well-proportioned bedrooms, both benefiting from built-in storage. This park home is a fantastic opportunity and must be viewed to avoid disappointment.

## Outside

Externally, the property benefits from driveway parking, leading to an enclosed garden with a patio area and lawn.

## Floorplan

### GROUND FLOOR

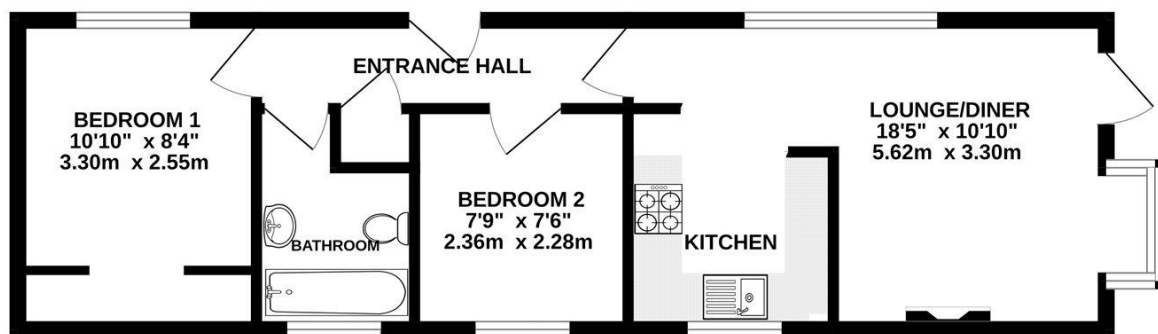

Whilst every attempt has been made to ensure the accuracy of the floorplan contained here, measurements of doors, windows, rooms and any other items are approximate and no responsibility is taken for any error, omission or mis-statement. This plan is for illustrative purposes only and should be used as such by any prospective purchaser. The services, systems and appliances shown have not been tested and no guarantee as to their operability or efficiency can be given.  
Made with Metropix ©2023



**TO ARRANGE A VIEWING PLEASE CONTACT:**  
Tel: **01252 361550** or Email: **info@bridges.co.uk**



**Important Notice** - These particulars are set out as a general outline only for the guidance of intended purchasers/tenants and do not form part of any offer or contract and must not be relied upon as statements or representations of fact. Purchasers/Tenants must satisfy themselves by inspection or otherwise as to their correctness.