



## Five Bedroom Detached House

**Mytchett Lake Road, Mytchett, Camberley, Surrey, GU16 6AL**

Price: £850,000

- No Chain
- Five Double Bedroom Detached
- Office
- Utility Room
- Kitchen/Diner
- Double Garage
- Walking Distance to Train Station
- EPC: D (68)



## Description

**\*\*NO CHAIN\*\*** Set within an exclusive cul-de-sac of only five properties, is this wonderful five double bedroom family home. The location spoils the occupier with a number of stunning nature spots, right on the very doorstep of the property - these include Mytchett Lake, Basingstoke canal and The Ranges woodland. The property as you enter boasts a spacious hallway, which then flows nicely into a spacious living room with feature wood burner and double doors - leading out onto the patio area. The rest of the downstairs benefits from an office, a beautiful kitchen/diner with stone work tops and a range cooker. There is also plenty of cupboard and worktop space, as well as double doors that lead into the garden. In addition the downstairs also includes a utility room and a cloakroom. Upstairs boasts five good size double bedrooms, an en-suite to bedroom one and a family bathroom suite.

## Outside

Outside boasts a beautiful treelined garden - including a large patio area perfect for entertaining and a wood frame gazebo, which makes ideal use for alfresco dining. The front of the house benefits from driveway parking for a number of vehicles, a double garage with power and lighting and side access.

## Floorplan

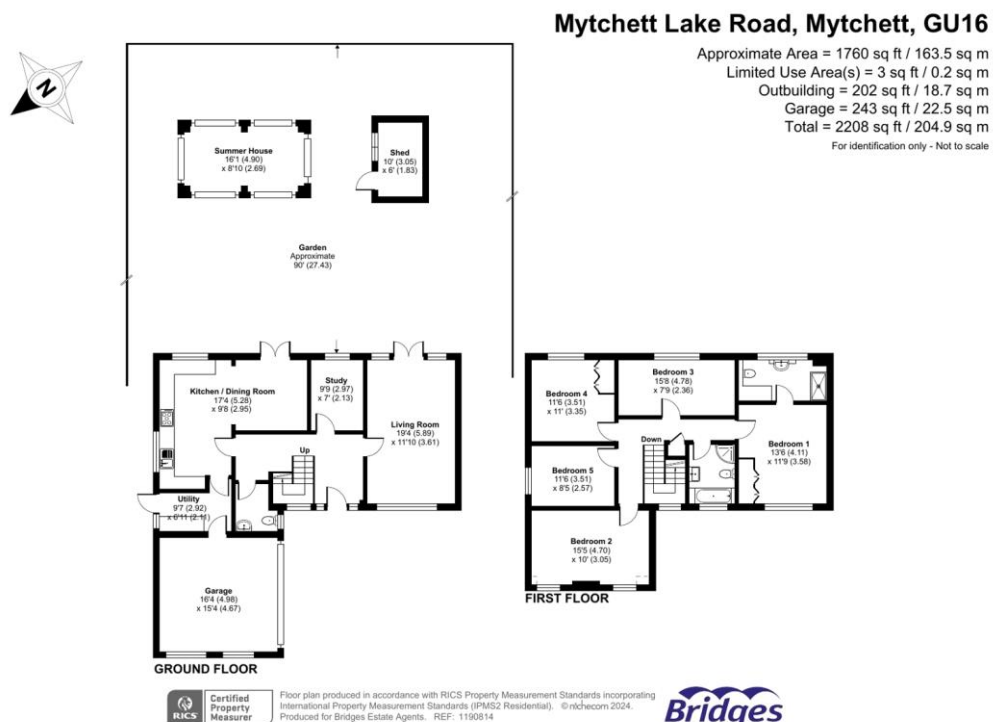

To arrange a viewing please contact:

Tel: 01252 361550

Email: [info@bridges.co.uk](mailto:info@bridges.co.uk)

Important Notice - These particulars are set out as a general outline only for the guidance of intended purchasers and do not form part of any offer or contract and must not be relied upon as statements or representations of fact. Purchasers must satisfy themselves by inspection or otherwise as to their correctness.