

Two Bedroom Apartment

Beverley House, Wallis Square, Farnborough, GU14 7GR

Guide Price: £237,500

- Two Bedroom Ground Floor Apartment
- Spacious Lounge/Diner
- Family Bathroom and En Suite
- Modern Fitted Kitchen
- Fitted Appliances
- Easy Access to the Town and Train Station
- Estimated Rental Price: £1,400pcm
- EPC: C (69)



Description

Bridges are delighted to offer this two double bedroom apartment with no onward chain, situated in the heart of Farnborough town centre and close to Farnborough train station which has links to London Waterloo in under 40 minutes. This property is well sized as it is bigger than the average apartment in the development. Internally the accommodation comprises of an open plan kitchen/living room, two double bedrooms with the main bedroom benefiting from an en suite shower room and built in wardrobes, and lastly a three piece family bathroom suite. This property would be perfect for first time buyers or an investor looking for a great investment opportunity.

Outside

Outside, there are well kept communal gardens and underground parking.

To view the Material Information Certificate for this property please click [Here](#) or contact us to request a copy.

Floorplan

GROUND FLOOR

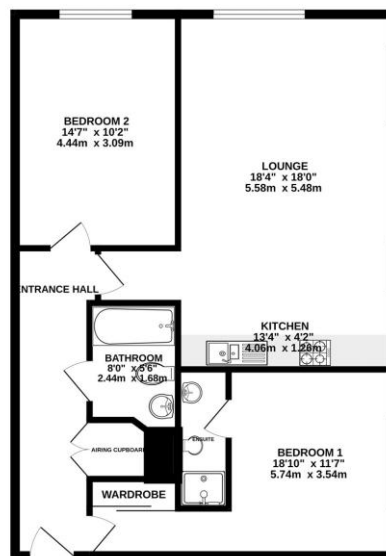

We have every attempt to ensure the accuracy of the floorplan contained here, measurements of doors, windows, rooms and any other items are approximate and no responsibility is taken for any error, omission or misstatement. This plan is for illustrative purposes only and should be used as such by any prospective purchaser. The services, fixtures and appliances shown here are for general interest and not guaranteed. Made with Housify 12/22



TO ARRANGE A VIEWING PLEASE CONTACT:
Tel: **01252 361550** or Email: **info@bridges.co.uk**



Important Notice - These particulars are set out as a general outline only for the guidance of intended purchasers/tenants and do not form part of any offer or contract and must not be relied upon as statements or representations of fact. Purchasers/Tenants must satisfy themselves by inspection or otherwise as to their correctness.