



One Bedroom Maisonette

Morval Close, Farnborough, Hampshire, GU14 0JF

Offers in excess of: £190,000

- One Double Bedroom
- First Floor Maisonette
- Living/Dining Room
- Residents and Visitors Parking
- Small Popular Development
- No Onward Chain
- Estimated Rental Price : £1,000 pcm
- EPC : D (62)



Description

Offered to the market with no onward chain is this one bedroom maisonette. This property is in a popular area within easy reach of local amenities, parks, road links, and Farnborough's main train station is approximately one mile away. Internally, the property benefits from a kitchen/living room, a double bedroom with built in storage, and a three piece bathroom suite. The property also benefits from resident parking. This maisonette is Cash buyers only. Viewings are highly recommended to appreciate in the property in full.

Outside

To the front of the property is a small garden which is mainly laid to lawn with a central path, plus a gravel area leading to the parking.

Floorplan

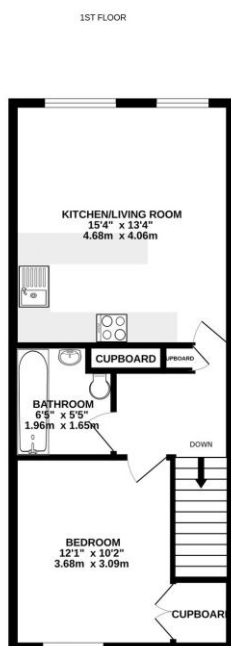

Whilst every attempt has been made to ensure the accuracy of the floorplan contained here, measurements of doors, windows, rooms and any other items are approximate and no responsibility is taken for any error, omission or misstatement. The plan is for illustrative purposes only and should be used as a guide only by any prospective purchaser. The services, fixtures and appliances shown here are not to be relied upon and no guarantee is given to their availability or efficiency can be given. Made with Metaphor 12/22



TO ARRANGE A VIEWING PLEASE CONTACT:
Tel: **01252 361550** or Email: **info@bridges.co.uk**



Important Notice - These particulars are set out as a general outline only for the guidance of intended purchasers/tenants and do not form part of any offer or contract and must not be relied upon as statements or representations of fact. Purchasers/Tenants must satisfy themselves by inspection or otherwise as to their correctness.