



One Bedroom Studio Apartment

Woodman Court, Albert Street, Fleet, Hampshire, GU51 3YE

Asking Price: £150,000

- Studio Apartment
- Refurbished Throughout
- Immaculate Condition
- Parking
- Communal Garden
- Fleet Town Centre
- Estimated Rental Price : £900 pcm
- EPC : D (56)



Description

Offered to the market, in immaculate condition throughout, is this recently refurbished studio apartment. Woodman Court is situated in the heart of Fleet town centre, being only a short walk from local shops, schools and amenities, as well as being walking distance of Fleet mainline train station. The property benefits from allocated parking to the rear, as well as a communal grassed garden area. The front door itself opens into the entrance hall with a wall of built in wardrobe space, and a modern shower room, At the end of the hallway you then enter the open plan living space which is cleverly constructed to offer designated areas for a kitchen, living and bedroom space.

Outside

Woodman Court offers a communal garden area as well as private parking to the rear. The door can be opened via a buzzer entry phone system.

Floorplan

GROUND FLOOR

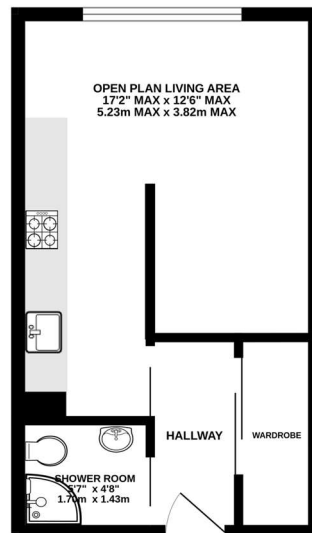

Whilst every attempt has been made to ensure the accuracy of the floorplan contained here, measurements of doors, windows, rooms and any other items are approximate and no responsibility is taken for any error, omission or mis-statement. This plan is for illustrative purposes only and should be used as such by any prospective purchaser. The services, systems and appliances shown have not been tested and no guarantee as to their operability or efficiency can be given.
Made with floorplan 10/2021



To arrange a viewing please contact:

Tel: 01252 361550

Email: info@bridges.co.uk

Important Notice - These particulars are set out as a general outline only for the guidance of intended purchasers and do not form part of any offer or contract and must not be relied upon as statements or representations of fact. Purchasers must satisfy themselves by inspection or otherwise as to their correctness.