



Four Bedroom Semi-Detached House

West End, Sherborne St. John, Basingstoke, Hampshire, RG24 9LE

Price: £550,000

- Four Double Bedrooms
- Spacious Kitchen
- Lounge/Dining Room
- Bathroom And Shower Room
- Village Location
- Views Over Farmland
- Parking and Car Port
- EPC : D (66)



Description

Offered to the market is this four double bedroom semi-detached chalet bungalow located in Sherbourne St John. The property has two bedrooms on the ground floor along with a lounge/dining room, and a spacious kitchen. The property is very versatile that the rooms are all good sized and work as a four bed or a three bed with an extra reception room. The ground floor also has a shower room, and space for a small study area. Upstairs there are two further double bedrooms and a family bathroom. Viewings are highly recommended.

Outside

To the front, there is ample driveway parking accessed via two five bar gates, and access to the car port via two doors. The rear garden is approximately 100 feet in length and backing onto farmland with mature shrubs and trees, a small pond, a greenhouse, a summerhouse, and is non overlooked and fully enclosed.

Floorplan

West End, Sherborne St. John, Basingstoke, RG24

Approximate Area = 1270 sq ft / 117.9 sq m (excludes carport)
 Limited Use Area(s) = 22 sq ft / 2 sq m
 Total = 1292 sq ft / 119.9 sq m
 For identification only - Not to scale

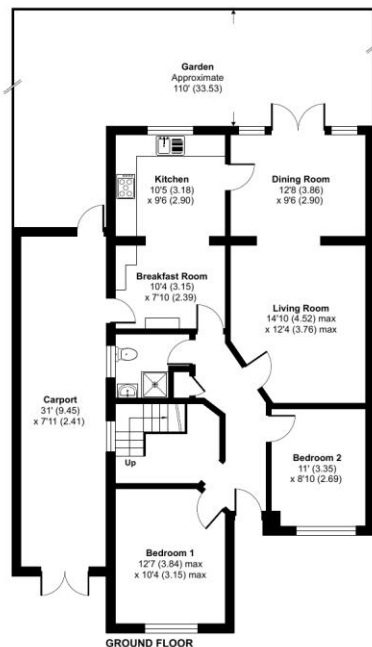

Denotes restricted head height

Floor plan produced in accordance with RICS Property Measurement 2nd Edition, incorporating International Property Measurement Standards (IPMS2 Residential). © richcom 2024. Produced for Bridges Estate Agents. REF: 1202050



TO ARRANGE A VIEWING PLEASE CONTACT:
 Tel: **01256 880001** or Email: **info@bridges.co.uk**



Important Notice - These particulars are set out as a general outline only for the guidance of intended purchasers/tenants and do not form part of any offer or contract and must not be relied upon as statements or representations of fact. Purchasers/Tenants must satisfy themselves by inspection or otherwise as to their correctness.