



Two Bedroom Apartment

Minley Road, Fleet, Hampshire, GU51 2AD

Price: £260,000

- Two Bedrooms
- Stunning Apartment
- Spacious Kitchen/Living Area
- Modern Bathroom
- Two Parking Spaces
- Less Than Two Years Old
- Walking Distance to Fleet Train Station
- EPC: B (81)



Description

Offered to the market and in immaculate condition, having been occupied for less than two years, is this wonderful flat in Infineon House which is situated just a short walk from Fleet train station. Upon entry, you are greeted with a spacious hallway, lift access, and a wide staircase. The property then offers two double bedrooms and a modern family bathroom. The stand out feature of the apartment is the open plan kitchen/living area, being extremely spacious and boasting a stylish kitchen and a light inviting space it is perfect for entertaining family/friends.

Outside

Superbly situated, being just a short walk from Fleet train station and a short drive from junction 4a of the M3 motorway, the property is ideal for commuters. Not only is the location ideal, but this property also boasts two parking spaces, a well kept communal area, and a lift.

Floorplan

SECOND FLOOR

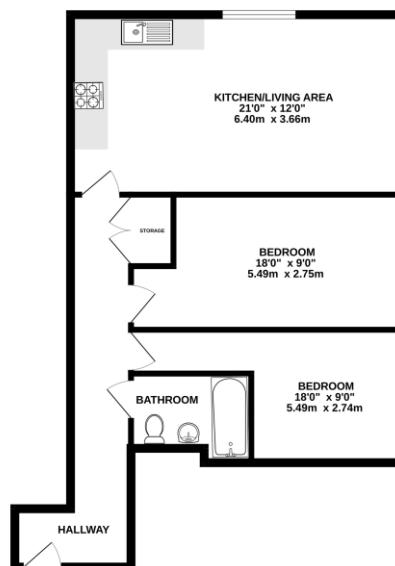

Whilst every attempt has been made to ensure the accuracy of the floorplan contained here, measurements of doors, windows, rooms and any other items are approximate and no responsibility is taken for any error, omission or misstatement. This plan is for illustrative purposes only and should be used as a guide only by any prospective purchaser. The services, equipment and appliances shown here are for illustrative purposes and no guarantee can be given. Made with Hogen 12/02



TO ARRANGE A VIEWING PLEASE CONTACT:
Tel: **01252 361550** or Email: **info@bridges.co.uk**



Important Notice - These particulars are set out as a general outline only for the guidance of intended purchasers/tenants and do not form part of any offer or contract and must not be relied upon as statements or representations of fact. Purchasers/Tenants must satisfy themselves by inspection or otherwise as to their correctness.