



Two Bedroom Terraced House

Mead Lane, Farnham, Surrey, GU9 7DY

Price: £335,000

- Two Bedroom Character Cottage
- Sitting Room with Exposed Brick Fireplace
- Farnham Town Location
- Contemporary Living Throughout
- Fitted Kitchen and Bathroom Suite
- Parking Available Nearby
- Courtyard Rear Garden
- EPC: D (67)



Description

A charming Victorian, two bedroom terraced cottage situated in Farnham town centre. This beautiful home offers the best of contemporary living while faithfully maintaining the original charm of the home. The downstairs comprises a cosy lounge with an exposed brick fireplace, which in turn leads to a smartly presented kitchen. The upstairs comprises two well proportioned bedrooms and a modern family bathroom suite.

Outside

The property benefits from having permit parking available close by. The courtyard rear gardens offers low maintenance and privacy, with a small outbuilding suitable utilised as a utility/storage room.

Floorplan

GROUND FLOOR

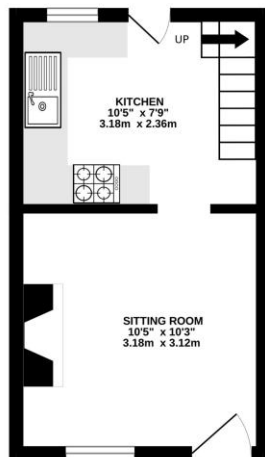

1ST FLOOR

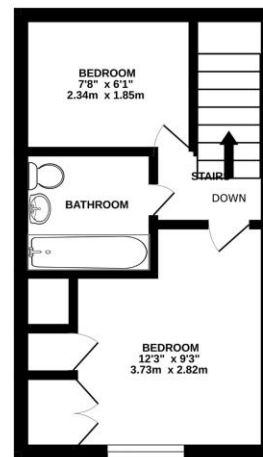

Whilst every attempt has been made to ensure the accuracy of the floorplan contained here, measurements of doors, windows, rooms and any other items are approximate and no responsibility is taken for any error, omission or mis-statement. This plan is for illustrative purposes only and should be used as such by any prospective purchaser. The services, systems and appliances shown have not been tested and no guarantee as to their operability or efficiency can be given.
Made with Metropex C2025



TO ARRANGE A VIEWING PLEASE CONTACT:
Tel: **01252 361550** or Email: **info@bridges.co.uk**



Important Notice - These particulars are set out as a general outline only for the guidance of intended purchasers/tenants and do not form part of any offer or contract and must not be relied upon as statements or representations of fact. Purchasers/Tenants must satisfy themselves by inspection or otherwise as to their correctness.