



Five Bedroom Detached House

Turstin Drive, Fleet, GU51 1GF

Price: £800,000

- Five Bedrooms
- Detached House
- Spacious Downstairs
- Kitchen/Dining Room
- Two En Suites
- Good Decorative Order
- Garden, Driveway, and a Double Garage
- EPC: C (80)



Description

This superbly sized five bedroom detached family home is situated in the ever popular Elvetham Heath and boasts lots of space for entertaining guests, with a generous double aspect living room, and an open plan kitchen/diner. There is a further reception room, which could be used as a playroom, study room, or even a dining room. Upstairs there are five bedrooms, enhancing the family home feel, and three bathrooms. Two of the bedrooms have en suites and four of the bedrooms have built-in wardrobes.

Outside

Turstin Drive is situated in the popular Elvetham Heath development which offers fantastic school catchment. The property benefits from driveway parking, a double garage, and side access round to the rear garden. The garden is private and mostly laid to lawn, with areas of patio and decking, which is perfect for al fresco dining.

Floorplan

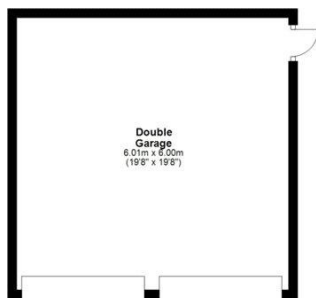

Ground Floor



First Floor



TO ARRANGE A VIEWING PLEASE CONTACT:
Tel: **01252 361550** or Email: **info@bridges.co.uk**



Important Notice - These particulars are set out as a general outline only for the guidance of intended purchasers/tenants and do not form part of any offer or contract and must not be relied upon as statements or representations of fact. Purchasers/Tenants must satisfy themselves by inspection or otherwise as to their correctness.