

## One Bedroom Apartment

**Farnborough Road, Farnborough, Hampshire, GU14 7GZ**

Offers in excess of: £215,000 *Leasehold*

- One Double Bedroom
- Ground Floor
- Modern Finish
- Allocated Parking
- Close to Farnborough Town Centre
- Estimated Rental Price : £1,250 pcm
- Gated Development
- EPC: D (65)

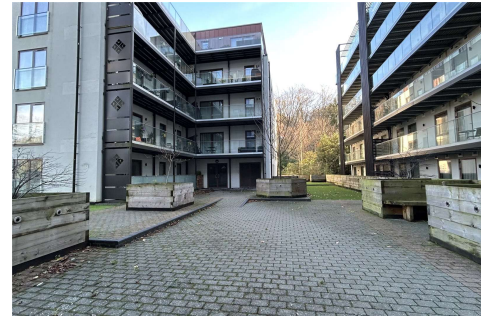

## Description

A modern and well presented one double bedroom apartment in a highly sought after gated development in Farnborough. The apartment offers an open plan living space, a kitchen which has been finished to a high standard, a modern bathroom, and a double bedroom with built in storage. The property also benefits from an allocated parking bay in the secure underground car park. The apartment is ideal for anyone commuting due to its location, being within close proximity to Farnborough Main train station which offers direct access to London Waterloo.

## Outside

Externally, the development has some well presented communal garden spaces and the property benefits from an allocated parking space in the secure underground car park.

## Floorplan

GROUND FLOOR

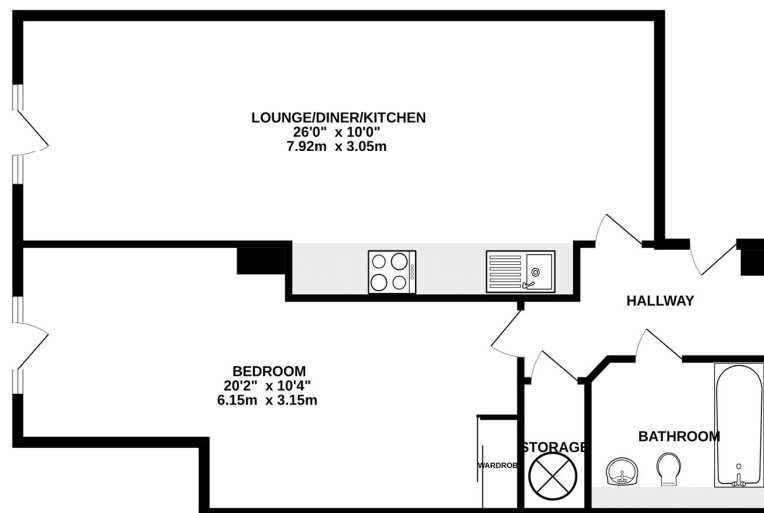

Whilst every attempt has been made to ensure the accuracy of the floorplan contained here, measurements of doors, windows, rooms and any other items are approximate and no responsibility is taken for any error, omission or mis-statement. This plan is for illustrative purposes only and should be used as such by any prospective purchaser. The services, systems and appliances shown have not been tested and no guarantee as to their operability or efficiency can be given.  
Made with Metronome ©2004



**TO ARRANGE A VIEWING PLEASE CONTACT:**  
Tel: **01252 361550** or Email: **info@bridges.co.uk**



**Important Notice - These particulars are set out as a general outline only for the guidance of intended purchasers/tenants and do not form part of any offer or contract and must not be relied upon as statements or representations of fact. Purchasers/Tenants must satisfy themselves by inspection or otherwise as to their correctness.**