



Two Bedroom Apartment

Ivy Close, Crookham Village, Fleet, Hampshire, GU51 5EW

Price: £385,000

- Two Bedrooms
- Ground Floor Apartment
- Two Bathrooms
- Spacious Kitchen/Living Area
- Stylishly Designed
- Berkley Homes Build
- Less than Two Years Old
- EPC: C (71)



Description

Offered to the market in the up-and-coming Hareshill development is this wonderful two bedroom ground floor apartment. Built less than two years ago, it is immaculate and tastefully decorated and designed. The property offers a spacious kitchen/living area, top of the range built-in appliances and is overall stylish and modern. Two double bedrooms are offered, both with built-in storage, and the principal bedroom offering an en suite bathroom. There is a further family bathroom, which follows the trend of the rest of the property and is sleek and well designed.

Outside

Located in the new and exclusive Hareshill development, with a superb school catchment, transport links to London and a short drive from the M3. The property benefits from allocated parking for two vehicles.

Floorplan

GROUND FLOOR

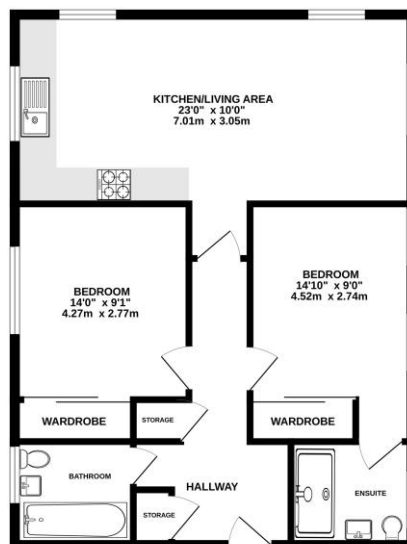

Whilst every effort has been made to ensure the accuracy of the floorplan contained here, measurements of doors, windows, rooms and any other items are approximate and no responsibility is taken for any errors, omissions or mis-statements. This plan is for guidance purposes only and should be used as such by any prospective purchaser. The contents, layout and appearance of the plan have not been tested and no guarantee as to their accuracy or efficiency can be given.
Made with Mapbox 12/24



TO ARRANGE A VIEWING PLEASE CONTACT:
Tel: **01252 361550** or Email: **info@bridges.co.uk**



Important Notice - These particulars are set out as a general outline only for the guidance of intended purchasers/tenants and do not form part of any offer or contract and must not be relied upon as statements or representations of fact. Purchasers/Tenants must satisfy themselves by inspection or otherwise as to their correctness.