



## Two Bedroom Detached Mobile Home

**The Willows Park, Guildford Road, Normandy, GU3 2BJ**

Price: £100,000

- Two Bedrooms
- No Chain
- Driveway Parking
- Private Garden
- Quiet Location
- Additional Residents Parking
- Walking Distance to Bus Stop
- EPC: TBC



## Description

Offered to the market with no onward chain is this park home for the over 50's, set within the popular Surrey Hills Park. The property has two bedrooms, a spacious living room and dining room - as well as a shower room/wet room. The site is located conveniently between Guildford and Ash Vale, with good bus connections both ways, whilst also being a very rural location.

## Outside

Outside boasts driveway parking, additional residents parking and a private garden.

## Floorplan

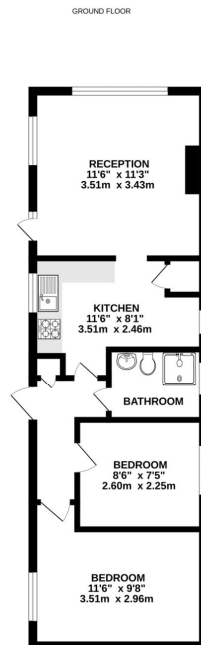

Whilst every attempt has been made to ensure the accuracy of the description contained herein, measurements of plots, sections, rooms and any other items are approximate and no responsibility is taken for any errors, omissions or misstatements. This plan is for illustrative purposes only and should be used as such by any prospective purchaser. The services, systems and appliances shown here are not guaranteed and no guarantee is given as to their quantity or efficiency can be given.  
Made with HomePlan 12/02



TO ARRANGE A VIEWING PLEASE CONTACT:  
Tel: **01252 361550** or Email: [info@bridges.co.uk](mailto:info@bridges.co.uk)



Important Notice - These particulars are set out as a general outline only for the guidance of intended purchasers/tenants and do not form part of any offer or contract and must not be relied upon as statements or representations of fact. Purchasers/Tenants must satisfy themselves by inspection or otherwise as to their correctness.