



## Four Bedroom Detached House

**Pennefather's Road, Wellesley, Aldershot, Hampshire, GU11 4BT**

Offers in excess of: £600,000

- Four Double Bedrooms
- Three Bathrooms
- Kitchen/Diner
- Garage and Parking
- Enclosed Rear Garden
- Immaculately Presented Throughout
- Situated in The Wellesley Development
- EPC: B (85)



# Description

A magnificent, detached family home, positioned on the fringes of the ever popular and sought after 'Wellesley Conservation Area'. Set over three floors and with internal accommodation presented in exceptional order throughout. The property benefits from four spacious double bedrooms, a kitchen/breakfast room as well as a garage. The ground floor boasts a welcoming entrance hall, which leads you to either the main lounge or a high gloss, fitted kitchen and dining area. The first floor offers a principal bedroom with an en suite - alongside a further bedroom with a premium bathroom. The third floor offers a further two double bedrooms, along with a Jack and Jill premium family bathroom. The property further benefits from a downstairs cloakroom - as well as a secluded established idyllic garden, driveway parking and a garage. Located just 1 mile from the train station, which offers direct links to London Waterloo - this exceptional family home is within walking distance of popular schools and relaxing walks in the Wellesley Conservation Area.

# Outside

Positioned on a generous plot, you can find a driveway to the rear with a garage. The property offers an attractive rear garden, incorporating an area of lawn, patio perfect for entertaining and is enclosed by a brick wall. The garden provides a good degree of privacy and seclusion.

# Floorplan

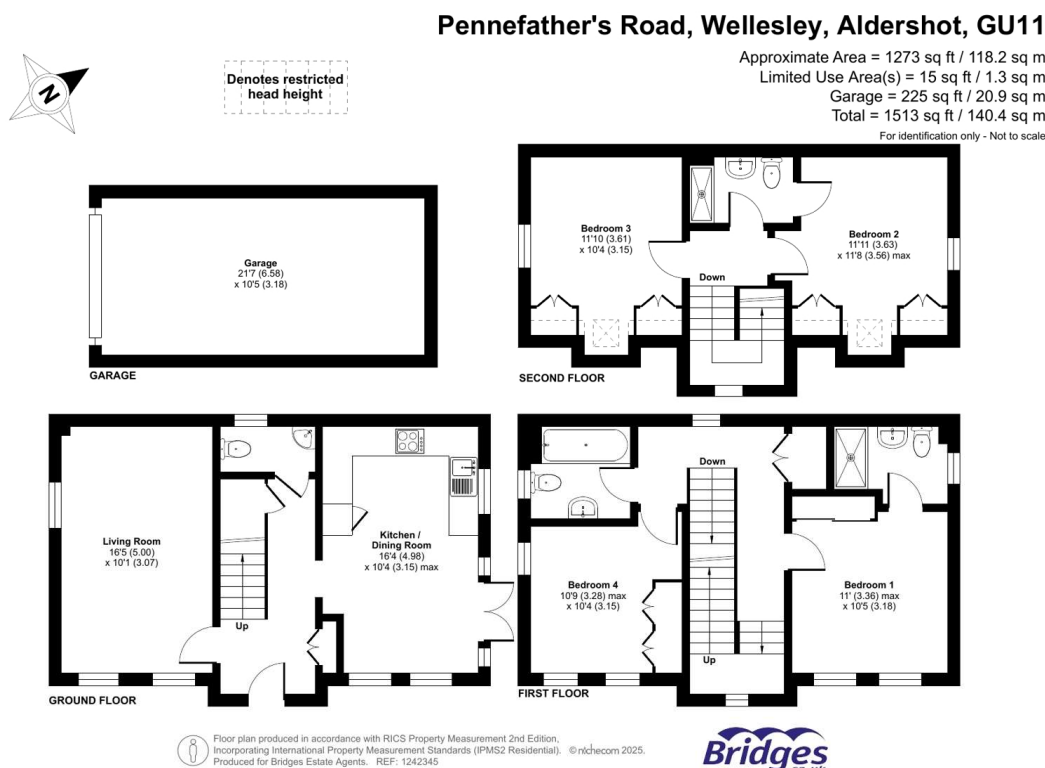

**TO ARRANGE A VIEWING PLEASE CONTACT:**

Tel: **01252 361550** or Email: **info@bridges.co.uk**

Important Notice - These particulars are set out as a general outline only for the guidance of intended purchasers/tenants and do not form part of any offer or contract and must not be relied upon as statements or representations of fact. Purchasers/Tenants must satisfy themselves by inspection or otherwise as to their correctness.