



Three Bedroom Maisonette

Halimote Road, Aldershot, Hampshire, GU11 1NJ

Price: £235,000

- Three Bedroom Split Level Maisonette
- Kitchen/Breakfast Room
- Allocated Parking
- Extended Lease on Completion to 162 Years
- Town Centre Location
- Walking Distance to Local Amenities
- No Onward Chain Complications
- EPC: D (60)



Description

A split-level maisonette, offered with no onward chain complication along with a newly extended lease on completion. Situated just a short walk to the town centre and the mainline train station, with a direct link to London Waterloo. On entering the property you are greeted with an entrance hall, leading to either the kitchen/breakfast room or the lounge. The first floor offers a principal bedroom with a further two bedrooms and a family bathroom. This exceptional family home is also within walking distance of popular schools.

Outside

Just a short walk to the mainline station with a direct link to London Waterloo. The property benefits from a driveway to the rear with outside space.

Floorplan

GROUND FLOOR

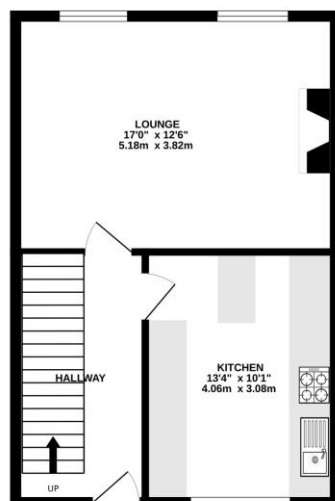

1ST FLOOR

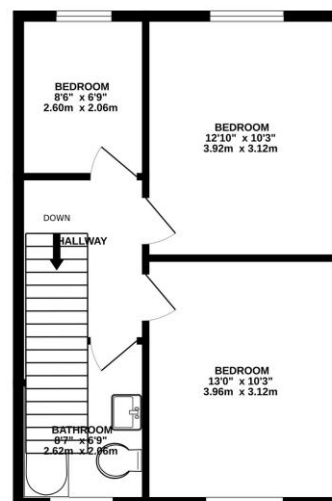

Whilst every attempt has been made to ensure the accuracy of the floorplan contained here, measurements of doors, windows, rooms and any other items are approximate and no responsibility is taken for any error, omission or mis-statement. This plan is for illustrative purposes only and should be used as such by any prospective purchaser. The services, systems and appliances shown have not been tested and no guarantee as to their operability or efficiency can be given.
Made with Metropac C2024



TO ARRANGE A VIEWING PLEASE CONTACT:
Tel: **01252 361550** or Email: **info@bridges.co.uk**



Important Notice - These particulars are set out as a general outline only for the guidance of intended purchasers/tenants and do not form part of any offer or contract and must not be relied upon as statements or representations of fact. Purchasers/Tenants must satisfy themselves by inspection or otherwise as to their correctness.