

One Bedroom Apartment Birchett Road, Aldershot, GU11 1FB

Guide Price: £150,000

- One Double Bedroom
- High Specification Apartments
- Integrated Appliances
- Contemporary Bathrooms
- Light and Spacious
- Town Centre Location
- Estimated Rental Figure: £1150pcm
- EPC: D (56)



Description

Situated in the heart of Aldershot town centre and within close proximity to the mainline station, this well presented top floor apartment is offered with no chain complications. This particular apartment offers spacious accommodation and plenty of natural light throughout. Accommodation comprises of a dual aspect reception room/kitchen with integrated appliances - as well as one double bedroom and a family bathroom. Give us a call today to book your viewing.

Outside

The property is approached via secure electric gates to the car parking - and also has a security entry phone system and allocated parking.

Floorplan

GROUND FLOOR

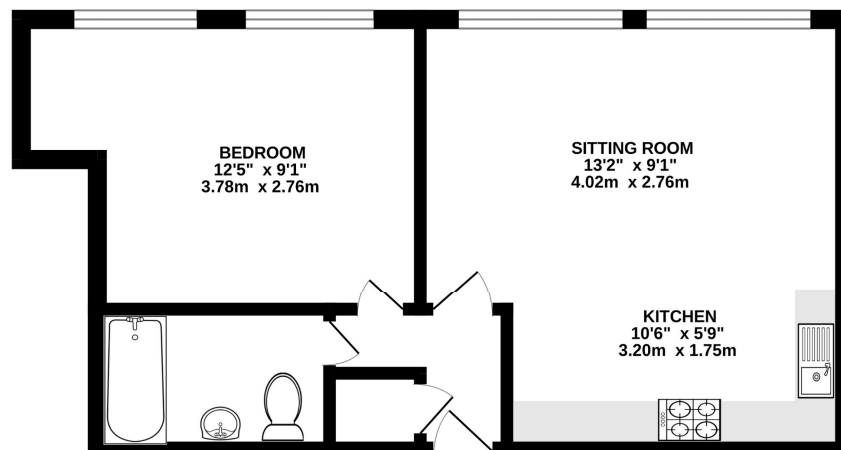

Whilst every attempt has been made to ensure the accuracy of the floorplan contained here, measurements of doors, windows, rooms and any other items are approximate and no responsibility is taken for any error, omission or mis-statement. This plan is for illustrative purposes only and should be used as such by any prospective purchaser. The services, systems and appliances shown have not been tested and no guarantee as to their operability or efficiency can be given.
Made with Metropix ©2024



TO ARRANGE A VIEWING PLEASE CONTACT:
Tel: **01252 361550** or Email: **info@bridges.co.uk**



Important Notice - These particulars are set out as a general outline only for the guidance of intended purchasers/tenants and do not form part of any offer or contract and must not be relied upon as statements or representations of fact. Purchasers/Tenants must satisfy themselves by inspection or otherwise as to their correctness.