



## Three Bedroom Detached House

**Redlands Farm Avenue, Sherfield-on-Loddon, Hook, Hampshire,**

**Price: £500,000**

- Three Bedroom Detached Home
- Spacious Kitchen/Dining Room
- Bright Living Room with Garden Access
- Modern Family Bathroom
- Well Established West Facing Garden
- Spacious Garage with Power and Lighting
- Driveway Parking for Multiple Vehicles
- EPC: B (84)





## Description

A well presented three bedroom detached home, located within the popular Longfield Place development in Sherfield on Loddon, built by Bellway Homes and purchased new by the current owners in 2022.

The ground floor offers a bright and spacious kitchen/dining room to the front of the property, ideal for both everyday living and entertaining. To the rear, the living room opens directly onto the garden, creating a seamless flow between indoor and outdoor space. Off the hallway, there is a generous downstairs cloakroom with potential to incorporate a utility area if required, along with a useful understairs storage cupboard accessed via the hallway.

Upstairs, the property features three well proportioned double bedrooms, along with a modern family bathroom and built-in storage off the landing.

## Outside

Outside, the west facing rear garden is a real highlight. It has been thoughtfully landscaped by the current owners to include a stylish new patio area and a variety of established planting, creating a private and inviting space that's ideal for relaxing or entertaining. There is side access leading from the garden to the long driveway, providing parking for multiple vehicles at the front. The property also benefits from a spacious garage with power and lighting, offering additional storage or potential for other uses. This modern home offers a great balance of comfort, practicality and outdoor space within a well regarded development.

## Floorplan

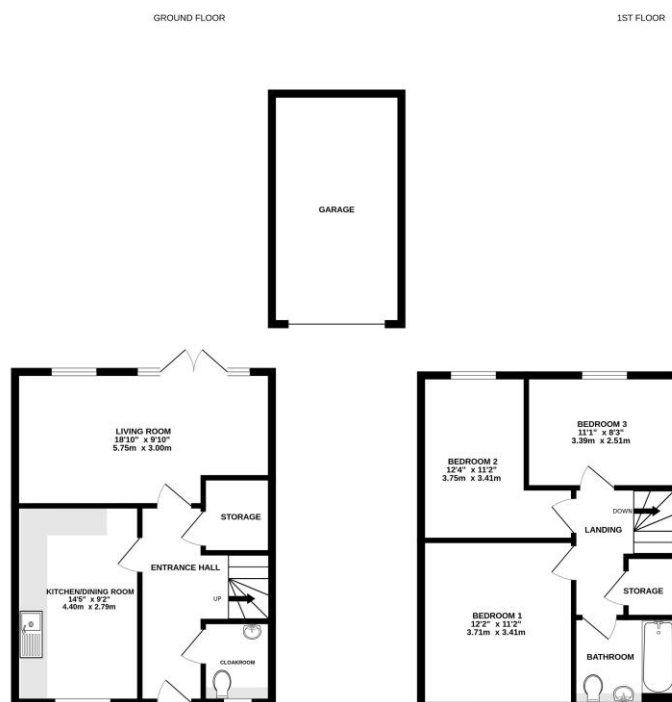

While every attempt has been made to ensure the accuracy of the floorplan contained herein, measurements of doors, windows, rooms and any other items are approximate and no responsibility is taken for any error, omission or mis-statement. This plan is for illustrative purposes only and should be used as such by any prospective purchaser. The services, systems and appliances shown have not been tested and no guarantee as to their operability or efficiency can be given.  
Made with Metropack C3002.



**TO ARRANGE A VIEWING PLEASE CONTACT:**  
Tel: **01256 769999** or Email: **info@bridges.co.uk**



**Important Notice** - These particulars are set out as a general outline only for the guidance of intended purchasers/tenants and do not form part of any offer or contract and must not be relied upon as statements or representations of fact. Purchasers/Tenants must satisfy themselves by inspection or otherwise as to their correctness.