



## One Bedroom Apartment

**Coombe Way, Farnborough, Hampshire, GU14 7GB**

Price: £175,000

- First Floor One Double Bedroom Apartment
- No Onward Chain
- Secure Entry System
- Gated Communal Gardens
- Close to the Town Centre
- Close to Mainline Station
- Open Plan Design
- EPC: B (81)





## Description

Situated within easy reach of Farnborough train station and town centre is this well presented one double bedroom first floor apartment. The property comprises a good sized entrance hallway with storage, three piece family bathroom, a double bedroom overlooking the garden, a fitted kitchen and a spacious lounge/diner offering views of the balcony gardens. The development boasts a secure entry system, lift access, gated communal garden areas and is a perfect position to enjoy all that Farnborough has to offer as well as the mainline station to London.

## Outside

The development benefits from a lovely sun deck offering a calming and peaceful space to relax accessed via the gate to the rear. There is a gated communal garden area to the front and rear of the apartment along with a secure children's play area perfect for any family.

## Floorplan

FIRST FLOOR

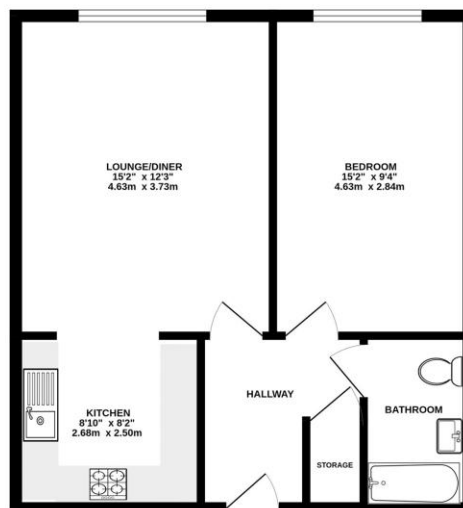

Whilst every attempt has been made to ensure the accuracy of the floorplan contained herein, measurements of doors, windows, stairs and any other items are approximate and no responsibility is taken for any error, omission or mis-statement. This plan is for guidance purposes only and should be used as such for any prospective purchaser. The correct name and address of the property must be used and no guarantee as to their accuracy or efficiency can be given. Made with Mapbox 10/20



**TO ARRANGE A VIEWING PLEASE CONTACT:**  
**Tel: 01252 361550 or Email: [info@bridges.co.uk](mailto:info@bridges.co.uk)**



**Important Notice - These particulars are set out as a general outline only for the guidance of intended purchasers/tenants and do not form part of any offer or contract and must not be relied upon as statements or representations of fact. Purchasers/Tenants must satisfy themselves by inspection or otherwise as to their correctness.**