



## One Double Bedroom Terraced Apartment

### New Poplars Court, Ash Street, Ash, Surrey, GU12 6LH

Price: £175,000

- One Bedroom Double Spacious Apartment
- Close Walk to Ash Rail Station
- Allocated Parking
- Lease of 155 Years
- Close Walking to Local Amenities
- Communal Garden
- No Chain
- EPC: C (73)





## Description

Located within walking distance of Ash rail station and the local amenities is this spacious and airy one double bedroom apartment. The apartment which is located on the second floor boasts a double bedroom, spacious living room, kitchen and bathroom. Viewings are highly recommended to appreciate the space and ideal location of this one double bedroom apartment.

## Outside

Outside boasts a well presented communal garden, allocated parking and visitor parking.

## Floorplan

2ND FLOOR

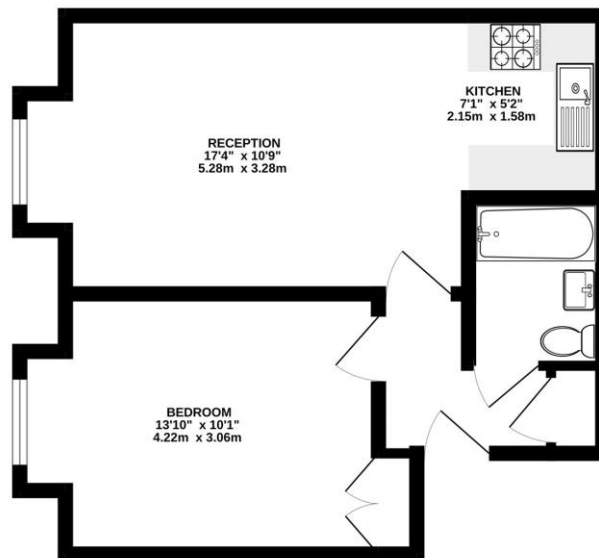

Whilst every attempt has been made to ensure the accuracy of the floorplan contained here, measurements of floors, windows, doors and any other items are approximate and no responsibility is taken for any error, omission or mis-statement. This plan is for illustrative purposes only and should not be used as such for any prospective purchase. The services, systems and appliances shown have not been tested and no guarantee as to their operability or efficiency can be given.  
Made with Metapix 02/05



**TO ARRANGE A VIEWING PLEASE CONTACT:**  
Tel: **01252 361550** or Email: **info@bridges.co.uk**



**Important Notice - These particulars are set out as a general outline only for the guidance of intended purchasers/tenants and do not form part of any offer or contract and must not be relied upon as statements or representations of fact. Purchasers/Tenants must satisfy themselves by inspection or otherwise as to their correctness.**