



One Double Bedroom Maisonette

Guildford Road, Farnham, Surrey, GU9 9PU

Offers in excess of: £200,000

- One Double Bedroom
- Split Level Maisonette
- Newly Refurbished
- Long Lease
- Peppercorn Ground Rent
- No Service Charges
- Short Walk from Town Centre
- EPC: D (64)



Description

A unique and fully refurbished split level maisonette which is within a short walk of both the town centre and Farnham Park. The entrance hall has stairs leading to a basement kitchen, a door to a ground floor living room and stairs leading to the first floor where the spacious and airy bedroom and bathroom can be found. This property must be viewed to be appreciated

Outside

The property is enclosed by a wall and a hedge with steps leading up to the front door.

Floorplan

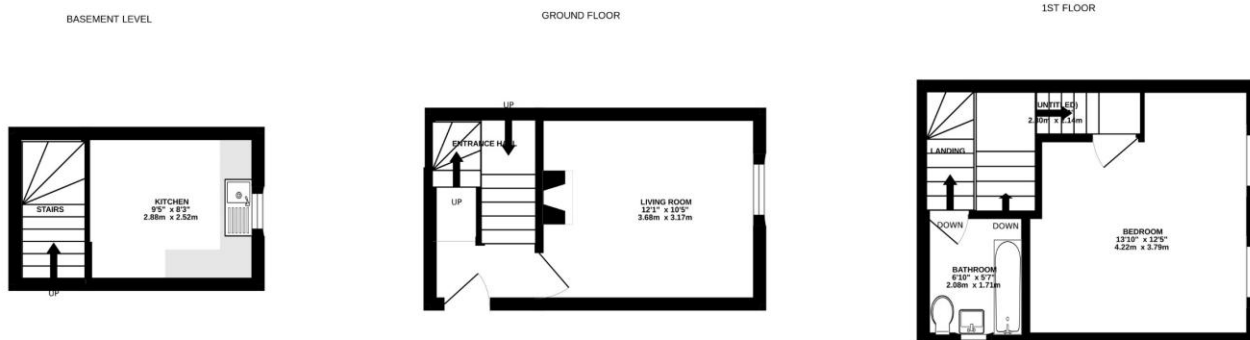

Whilst every attempt has been made to ensure the accuracy of the floorplan contained here, measurements of doors, windows, rooms and any other items are approximate and no responsibility is taken for any error, omission or mis-statement. This plan is for illustrative purposes only and should be used as such by any prospective purchaser. The services, systems and appliances shown have not been tested and no guarantee as to their operability or efficiency can be given.
Made with Metropix ©2025



TO ARRANGE A VIEWING PLEASE CONTACT:
Tel: **01252 361550** or Email: **info@bridges.co.uk**



Important Notice - These particulars are set out as a general outline only for the guidance of intended purchasers/tenants and do not form part of any offer or contract and must not be relied upon as statements or representations of fact. Purchasers/Tenants must satisfy themselves by inspection or otherwise as to their correctness.