



## Two Bedroom Apartment

**Station Road, Hook, Hampshire, RG27 9QR**

**Price: £295,000**

- Two Double Bedrooms
- Juliet Balcony
- Open Plan Living Space
- Stylish Modern Kitchen
- En Suite to Main Bedroom
- Two Allocated Parking Spaces
- No Onward Chain
- EPC: B (85)





## Description

Situated within the sought after Bartley Square development in Hook, this beautifully presented two bedroom apartment offers stylish and comfortable living with a modern finish throughout. The heart of the home is a bright and spacious open plan kitchen/living/dining area, designed for both everyday living and entertaining. With dual aspect windows and a Juliet balcony, the space feels airy and welcoming, while the sleek kitchen is fully fitted with integrated appliances and contemporary units. Quality Karndean flooring flows through much of the apartment, adding a smart and practical touch. Both bedrooms are generous doubles, with the main bedroom benefitting from a well finished en suite shower room. A modern bathroom completes the layout, creating a home that's as functional as it is inviting.

## Outside

Set on the second floor of this attractive development, the apartment is served by a secure entry system and a lift to all floors. Two allocated undercover parking spaces are included, along with access to landscaped communal gardens that provide a pleasant green outlook. Bartley Square enjoys a convenient yet peaceful position within Hook, close to the village centre, local schools and open countryside. Hook station is just a short walk away, offering direct services to London Waterloo in under 45 minutes, while the M3 is easily accessible for road links. The village high street, with its independent shops, cafes and local amenities, adds to the community feel that makes Bartley Square such a popular place to call home.

To view the Material Information Certificate for this property please click [Here](#) or contact us to request a copy.

## Floorplan

SECOND FLOOR

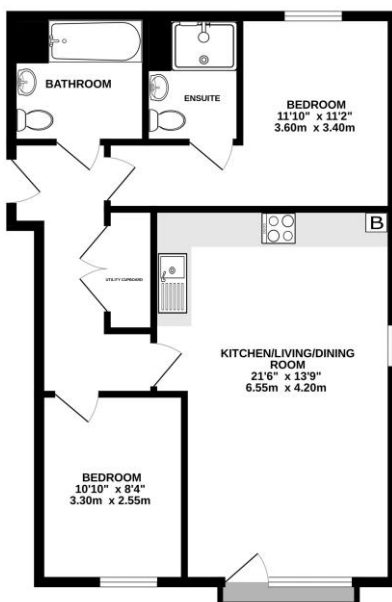

Whilst every attempt has been made to ensure the accuracy of the floorplan contained herein, measurements of floors, windows, rooms and any other items are approximate and no responsibility is taken for any error, omission or misstatement. This plan is for illustrative purposes only and should be used as such for any prospective purchase. The services, systems and appliances shown have not been tested and no guarantee is made for their operation or efficiency can be given.  
Made with Hectag 12/2025



**TO ARRANGE A VIEWING PLEASE CONTACT:**  
Tel: **01256 769999** or Email: **info@bridges.co.uk**



**Important Notice** - These particulars are set out as a general outline only for the guidance of intended purchasers/tenants and do not form part of any offer or contract and must not be relied upon as statements or representations of fact. Purchasers/Tenants must satisfy themselves by inspection or otherwise as to their correctness.