

Two Bedroom Semi-Detached House

The Green, Frogmore, Camberley, Hampshire, GU17 0NT

Guide Price: £375,000

- Two Bedrooms
- Semi-Detached House
- Two reception rooms
- Utility Area
- Enclosed Rear Garden
- Close to Local Amenities
- No Onward Chain
- EPC: F (23)



Description

Offered for sale with No Onward Chain stands this Charming 2 bedroom Victorian Cottage. Nestled in the heart of Frogmore, this delightful 2 bedroom Victorian cottage offers the perfect blend of period charm and modern convenience. This property boasts two spacious reception rooms, ideal for entertaining or relaxing with family. The well appointed kitchen features ample storage and workspace, while the bathroom ensures comfort for you and your guests. Both front and rear gardens provide lovely outdoor spaces for gardening or al fresco dining. Conveniently located close to local amenities and just a short stroll from excellent road and rail links, this home is perfect for commuters and families alike. Don't miss the opportunity to make this exquisite cottage your own. Schedule a viewing today!

Outside

Front and rear gardens provide lovely outdoor spaces for gardening or al fresco dining.

To view the Material Information Certificate for this property please click [Here](#) or contact us to request a copy.

Floorplan

GROUND FLOOR

1ST FLOOR

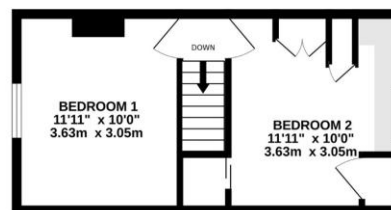
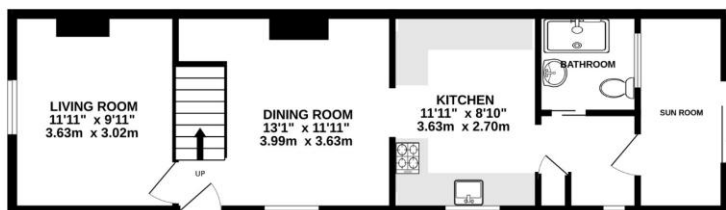

Whilst every attempt has been made to ensure the accuracy of the floorplan contained here, measurements of doors, windows, rooms and any other items are approximate and no responsibility is taken for any error, omission or mis-statement. This plan is for illustrative purposes only and should be used as such by any prospective purchaser. The services, systems and appliances shown have not been tested and no guarantee as to their operability or efficiency can be given.
Made with Metropix ©2025



TO ARRANGE A VIEWING PLEASE CONTACT:

Tel: 01276 685544 or Email:

camberley@bridges.co.uk



Important Notice - These particulars are set out as a general outline only for the guidance of intended purchasers/tenants and do not form part of any offer or contract and must not be relied upon as statements or representations of fact. Purchasers/Tenants must satisfy themselves by inspection or otherwise as to their correctness.