



## One Double Bedroom Apartment

**Collingwood, Farnborough, Hampshire, GU14 6LX**

Price: £210,000

- One Double Bedroom
- Ground Floor Apartment
- Patio Area
- Two Parking Spaces
- Close to Transport Links
- Cul-de-Sac Location
- No Onward Chain
- EPC: C (70)





## Description

Coming to the market with no onward chain complications, is this deceptively spacious one bedroom ground floor apartment. The property consists of a double bedroom, a bright and airy living room, with a separate kitchen. There is also bike storage, quiet communal grounds and good access to the A331 and M3.

## Outside

Coming with two parking spaces, a patio area accessible from double doors off your living room and being tucked away at the bottom of a quiet cul-de-sac, this home is ideal for first time buyers, downsizers and investors alike.

To view the Material Information Certificate for this property please click [Here](#) or contact us to request a copy.

## Floorplan

GROUND FLOOR

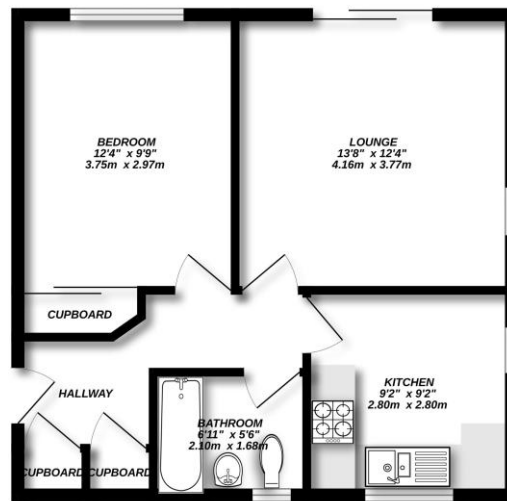

Made with Metaplan 02025



TO ARRANGE A VIEWING PLEASE CONTACT:  
Tel: **01252 361550** or Email: **info@bridges.co.uk**



Important Notice - These particulars are set out as a general outline only for the guidance of intended purchasers/tenants and do not form part of any offer or contract and must not be relied upon as statements or representations of fact. Purchasers/Tenants must satisfy themselves by inspection or otherwise as to their correctness.