



## Three Bedroom Detached Bungalow

**Shawfield Road, Ash, Surrey, GU12 6RB**

Offers in excess of: £400,000

- Three Bedrooms
- Detached Bungalow
- Generous Plot
- Kitchen / Dining Room
- Driveway Parking
- Walking Distance to Local Amenities
- Private Low Maintenance Garden
- EPC: D (61)



## Description

Located within a popular location within the village, is this spacious detached bungalow with a generous size plot, the property is conveniently located within walking distance of the local amenities and Ash rail station. The bungalow boasts three bedrooms, a bathroom suite, sizeable kitchen/dining area and a spacious living room with doors which lead out into the garden.

## Outside

Outside benefits from driveway parking, a well presented, private and low maintenance enclosed garden and a storage shed.

To view the Material Information Certificate for this property please click [Here](#) or contact us to request a copy.

## Floorplan

### GROUND FLOOR

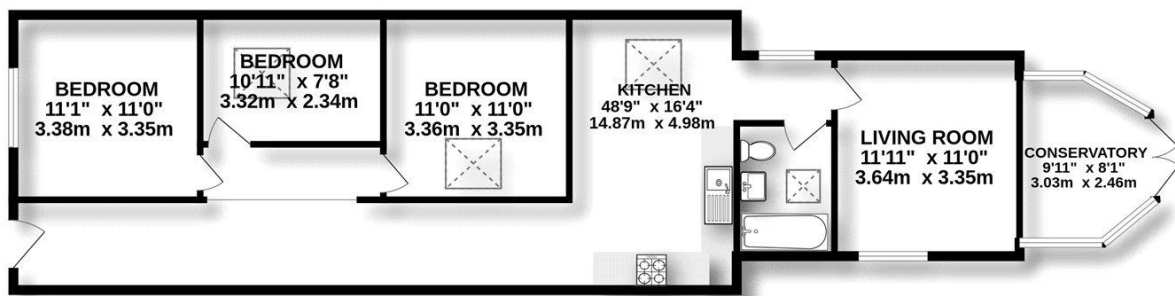

Measurements are approximate. Not to scale. Illustrative purposes only  
Made with Metropix ©2025



**TO ARRANGE A VIEWING PLEASE CONTACT:**  
Tel: **01252 361550** or Email: **info@bridges.co.uk**



Important Notice - These particulars are set out as a general outline only for the guidance of intended purchasers/tenants and do not form part of any offer or contract and must not be relied upon as statements or representations of fact. Purchasers/Tenants must satisfy themselves by inspection or otherwise as to their correctness.